



Public Design

stilum 
PARK





stilum is unique – and
complies with all the
requirements of public
spaces.

Modern design in
perfection offers
completely new
possibilities of emphasizing
architecture and landscape
design.

stilum leaves a decisive
imprint on the overall image
of any area and handles the
resource of free space with
caution.

Components and materials
of highest quality guarantee
a long useful life.

stilum products are
exclusively manufactured in
Germany and, as a matter
of fact, comply with all the
relevant standards.

Welcome at the world of stilum





Quality
made in germany

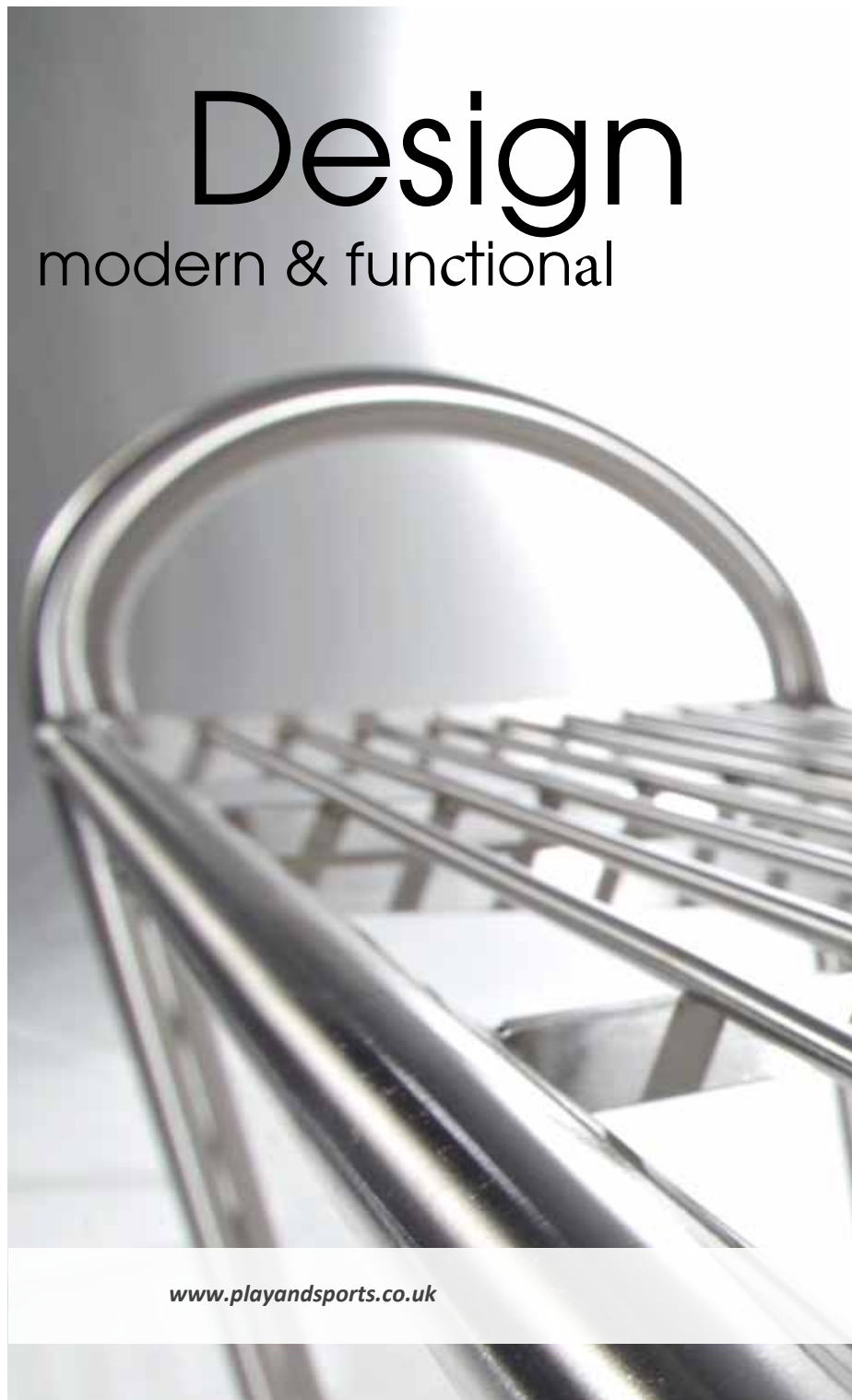

Design
modern & functional

www.playandsports.co.uk



Material

– high quality & constancy

This is unmistakably stilum!

www.playandsports.co.uk



Stainless Steel



Rubber Granule



Hardwood



stilum

by people for people

Seats	8 – 33
Trash bins	34 – 39
Waiting area	40 – 43
Illumination	44 – 49
Bicycle stands	50 – 59
Media vehicles & shadowing elements	60 – 67
Noise absorbing walls & visual protection	68 – 71
Design elements	72 – 77
Vases	78 – 87
Technical information	88 – 98



What impression do we want to leave? How much do we care about citizens and guests? What does quality of life mean to us? The answers to these questions make up the requirements for designing free spaces. A bench of an extraordinary design or loungers have a strong signal effect, because they attract attention and, at the same time, invite to stay and relax.

lignum2	10 – 11
unio1 – unio2	12 – 13
unio	14
tabula with back rest	15
tabula	16 – 17
obsita	18 – 19
placidus1 (Wood)	20
placidus3 (Wood)	21
placidus1 VA	22
placidus2 VA	23
placidus1 VA with Backrest	24 – 25
placidus3	26
mensa	27
primus	28
decos ilex	29
ligna	30 – 31
decos	32 – 33



Seats

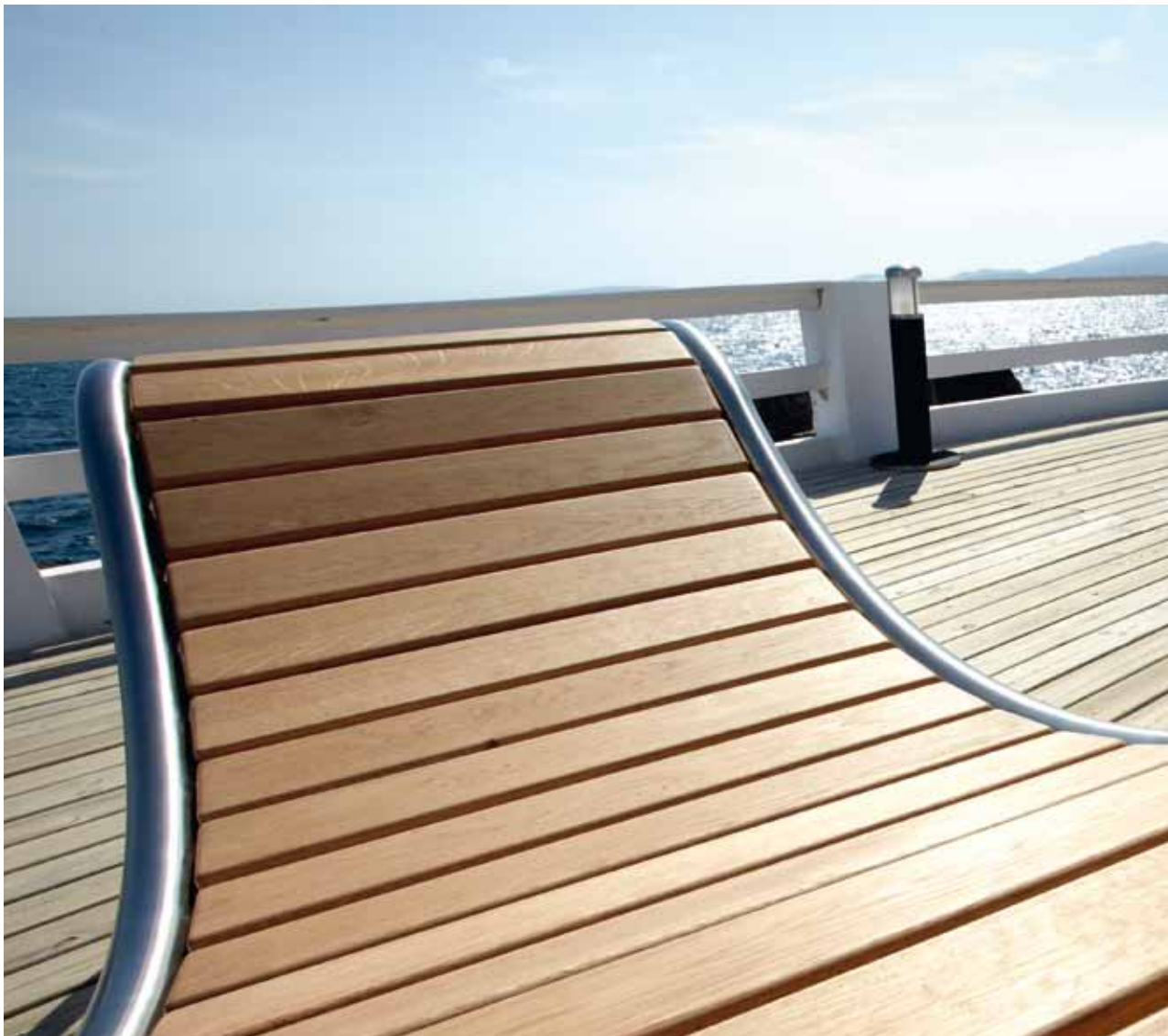

The lounge "lignum2" with its unmistakable signal character.



Lounger "lignum2"

Stainless steel, with wheel
(mobile) with hardwood as seat

Item No. 57 1027 402

Stainless steel, without wheel (fixed in foundation)
with hardwood as seat

Item No. 57 1027 401

(LxBxH) Equipment dimensions

2673 x 710 x 758 mm

Recommended surface material optional

All rights and product modifications reserved.

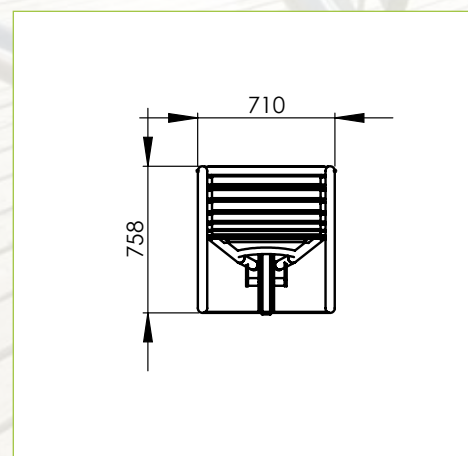
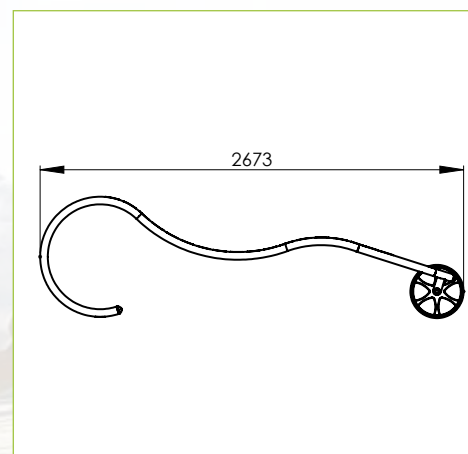

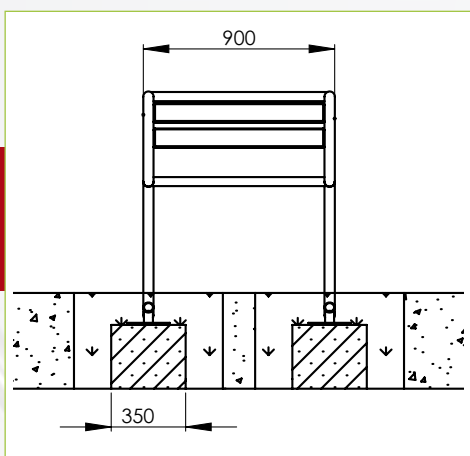
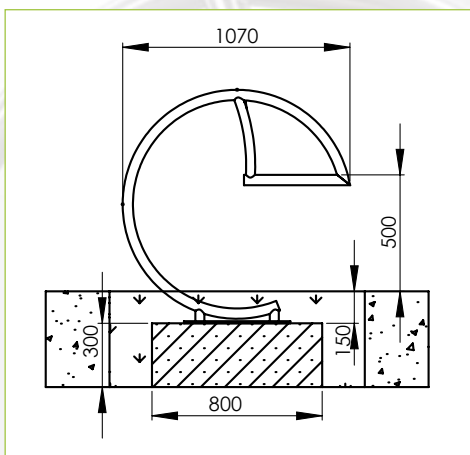

Seat "unio1"

Stainless steel with hardwood as seat

Item No. 57 1025 401

(LxBxH) Equipment dimensions

900 x 1075 x 1085 mm

(after installation: 935 mm)

Height of seat

500 mm

Recommended surface material

optional

All rights and product modifications reserved.

Bench "unio2"

Stainless steel
with hardwood as seat

Item No. 57 1026 401

(LxBxH) Equipment
dimensions

1740 x 1075 x 1085 mm

(height after installation: 935 mm)

Height of seat

500 mm

Recommended surface
material

optional

All rights and product modifications reserved.

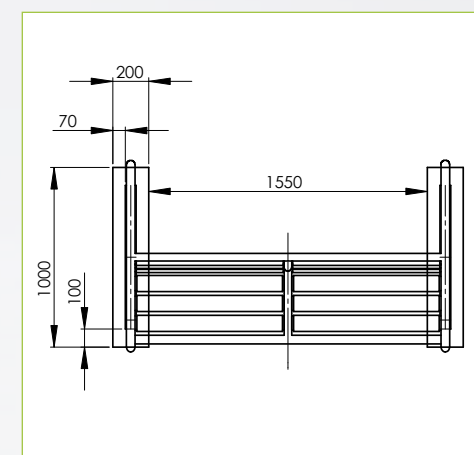
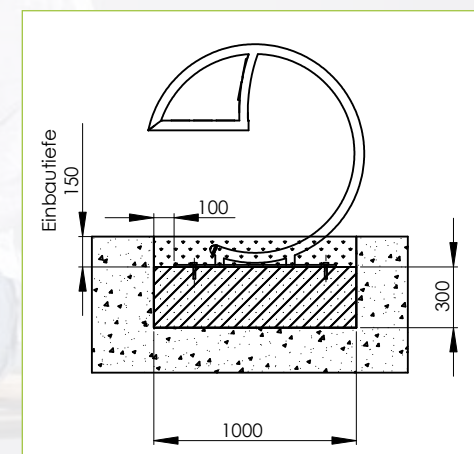

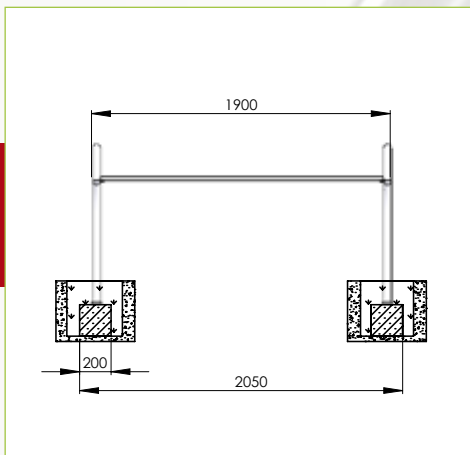
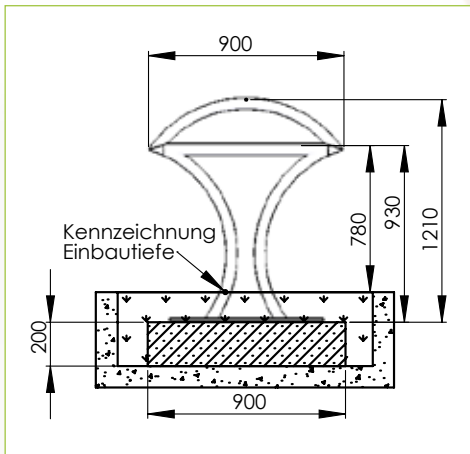

Table "unio"

Stainless steel
with hardwood as table top

Item No. 57 1029 401

(LxBxH) Equipment
dimensions

1900 x 890 x 1210 mm

Height of table

830 mm

Recommended surface
material

optional

unio is available as a stand-alone table or can be fixed in a concrete foundation.

All rights and product modifications reserved.

Bench "tabula" with back rest

Stainless steel
with hardwood as table top and seat

Item No. 57 1028 402

(LxBxH) Equipment
dimensions

1900 x 2100 x 1020 mm

Height of table

780 mm

Height of seat

500 mm

Recommended surface
material

optional

All rights and product modifications reserved.

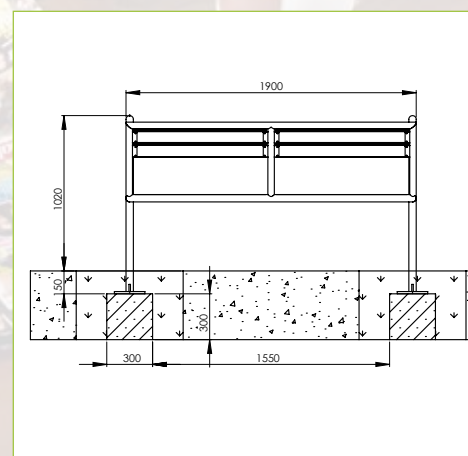
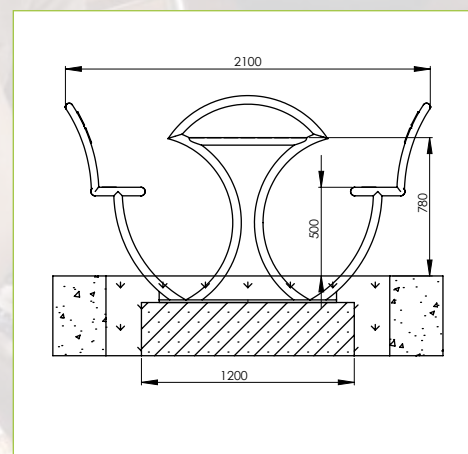



*stilum seats attract attention and
invite to stay and relax.*



www.playandsports.co.uk

Bench "tabula"

Stainless steel
with hardwood as table top and seat

Item No. 57 1028 401

(LxBxH) Equipment dimensions 1900 x 1650 x 1220 mm

Height of table 780 mm

Height of seat 500 mm

Recommended surface material optional

All rights and product modifications reserved.

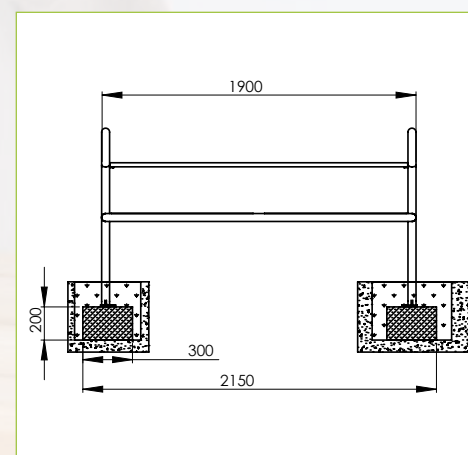
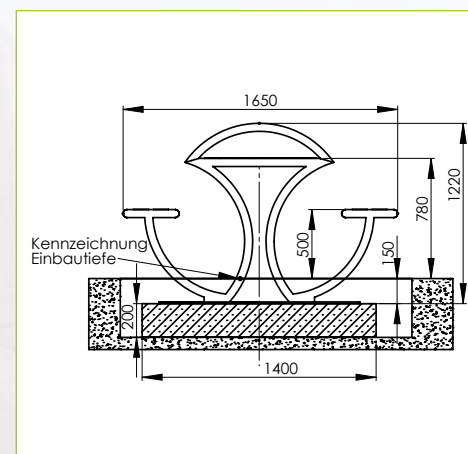



A bench with added value – typically stilum!



www.playandsports.co.uk

Bench "obsita"

Stainless steel
with hardwood as seat

Item No. 57 1033 401

(LxBxH) Equipment
dimensions

1800 x 1600 x 900 mm

Height of seat

500 mm

Recommended surface
material

optional

obsita is available as a stand-alone bench or can be fixed in a concrete foundation.

All rights and product modifications reserved.

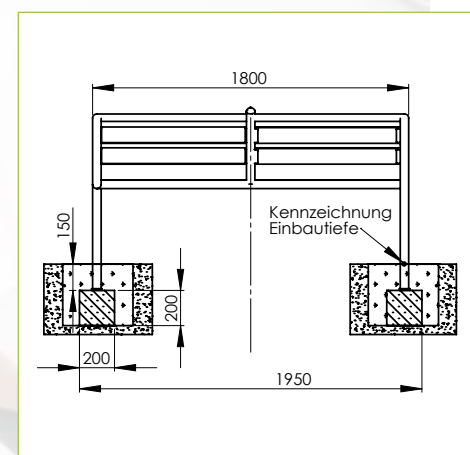
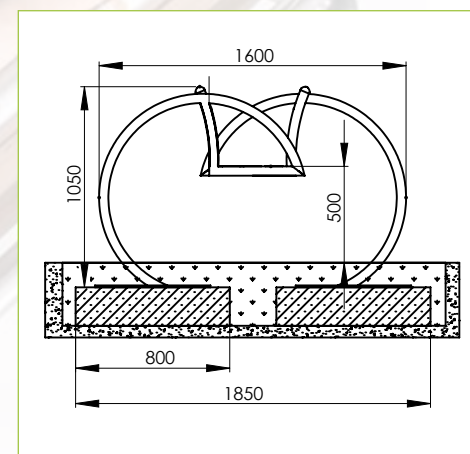

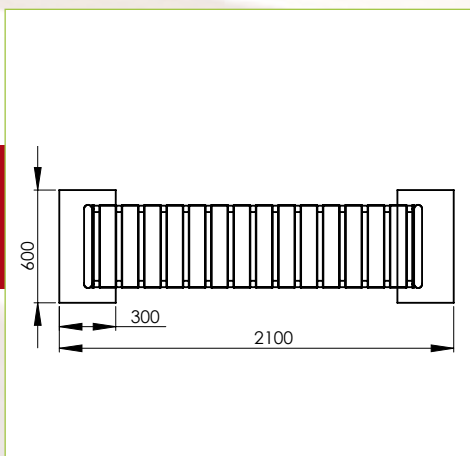
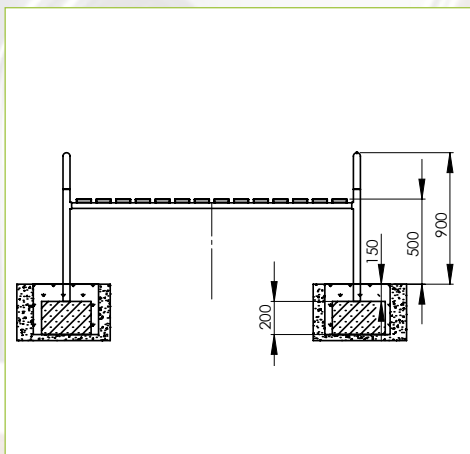

Bench "placidus1" (Wood)

Stainless steel
with hardwood as seat

Item No. 57 1032 402

(LxBxH) Equipment
dimensions

1800 x 450 x 900 mm

Height of seat

500 mm

Recommended surface
material

optional

All rights and product modifications reserved.

Bench "placidus3" (Wood)

Stainless steel
with hardwood as seat

Item No. 57 1031 402

(LxBxH) Equipment
dimensions

1900 x 700 x 900 mm

Height of seat

500 mm

Recommended surface
material

optional

All rights and product modifications reserved.

>> TIP

Combinations see

"placidus3" on page 26!

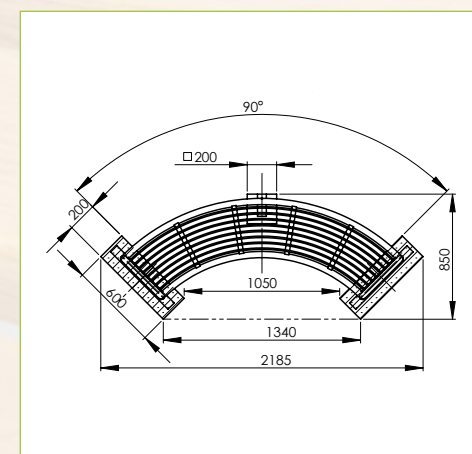
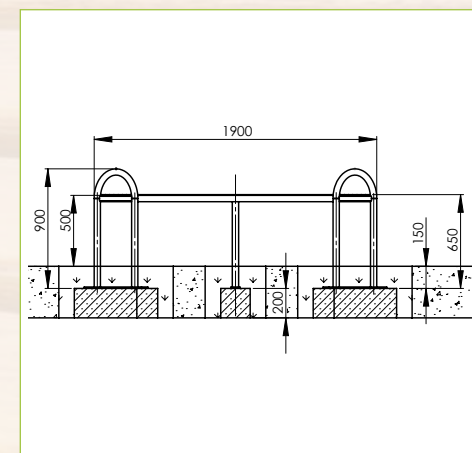

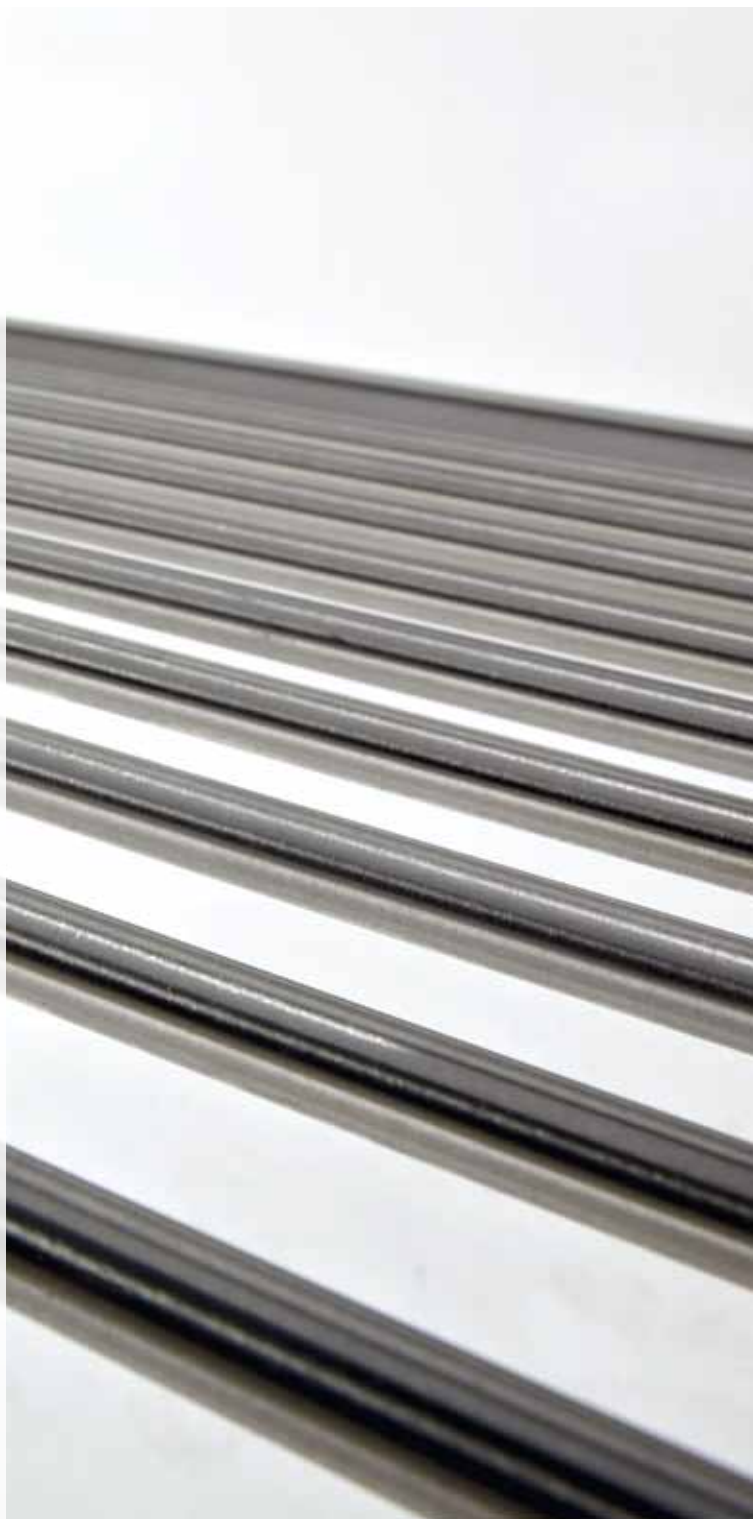
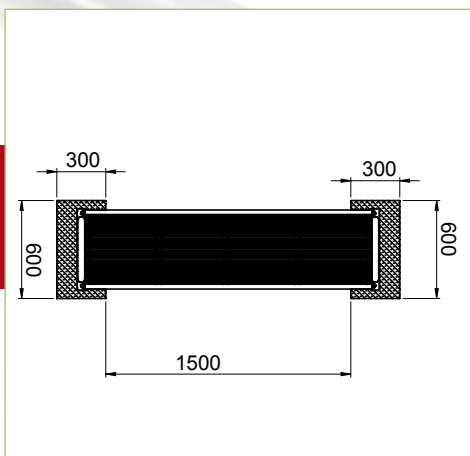
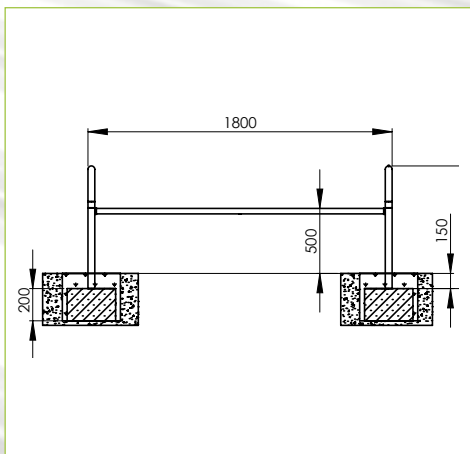

Bench "placidus1"

Stainless steel

Item No. 57 1032 401

(LxBxH) Equipment
dimensions

1800 x 450 x 900 mm

Height of seat

500 mm

Recommended surface
material

optional

All rights and product modifications reserved.

Bench "placidus2"

Stainless steel without back rest Item No. 57 1030 401

Stainless steel with back rest Item No. 57 1030 402

(LxBxH) Equipment dimensions 2050 x 442 x 650 mm

Height of seat 500 mm

Recommended surface material optional

All rights and product modifications reserved.

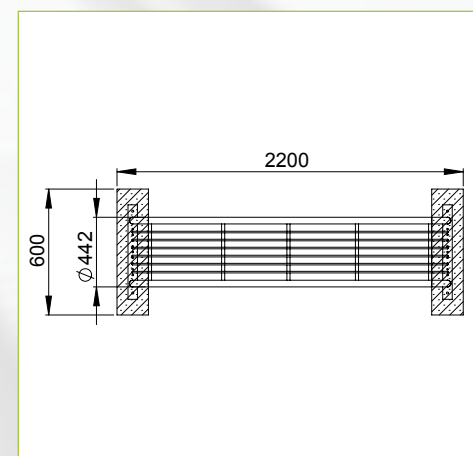
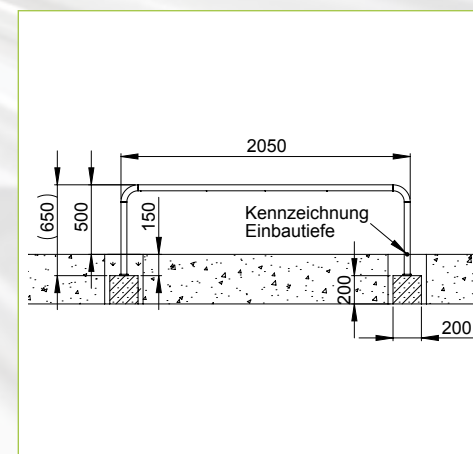
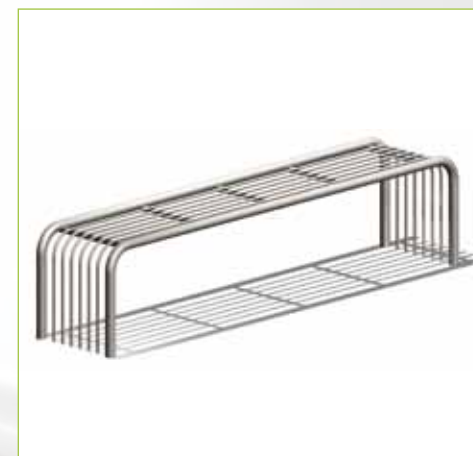



*High-quality, long-lasting material
and a clear design
–that’s unmistakably stilum.*

>> TIP

Supplementary range from page 36!



Bench "placidus1" with back rest

Stainless steel

Item No. 57 1032 403

(LxBxH) Equipment
dimensions

1800 x 450 x 1050 mm

Height of seat

500 mm

Recommended surface
material

optional

All rights and product modifications reserved.

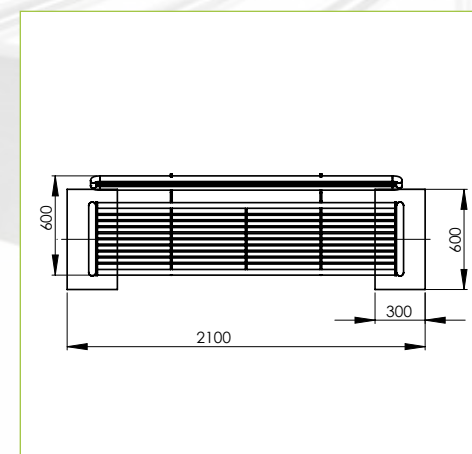
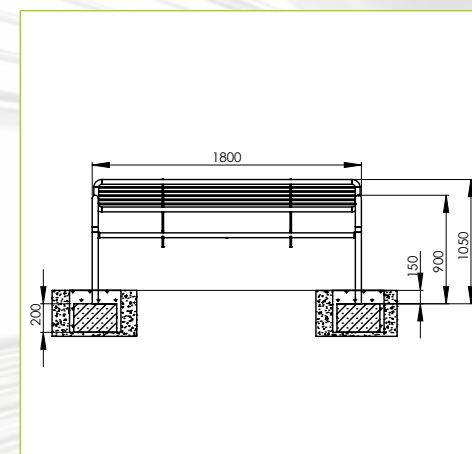

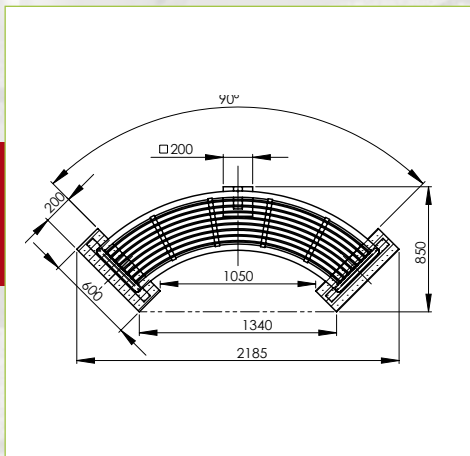
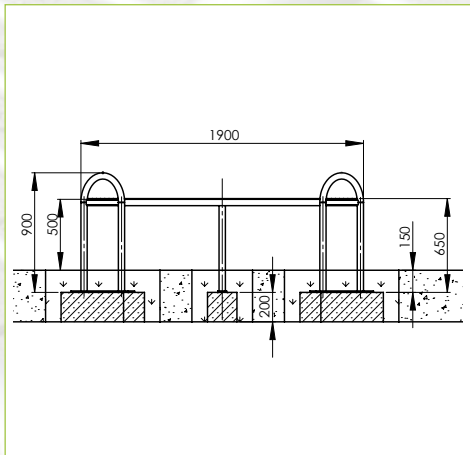

Bench "placidus3"

Stainless steel	Item No. 57 1031 401
(LxBxH) Equipment dimensions	1920 x 700 x 900 mm
Height of seat	500 mm
Recommended surface material	optional
All rights and product modifications reserved.	



Table "mensa"

Stainless steel	Item No. 57 1520 401
Layer	granite
(LxBxH) Equipment dimensions	2150 x 850 x 930 mm
Height of table	780 mm
All rights and product modifications reserved.	

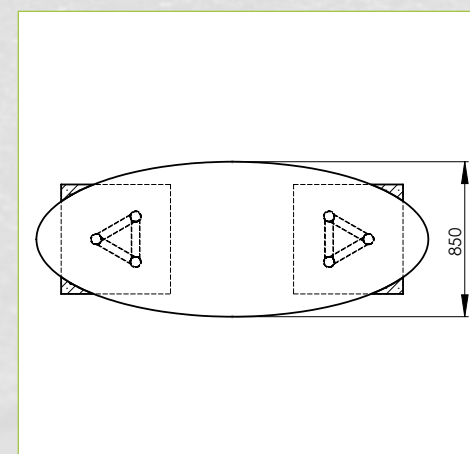
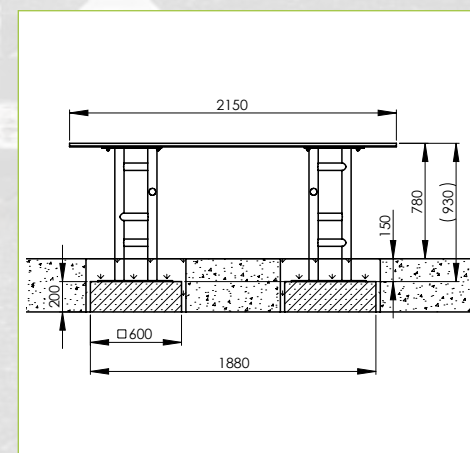

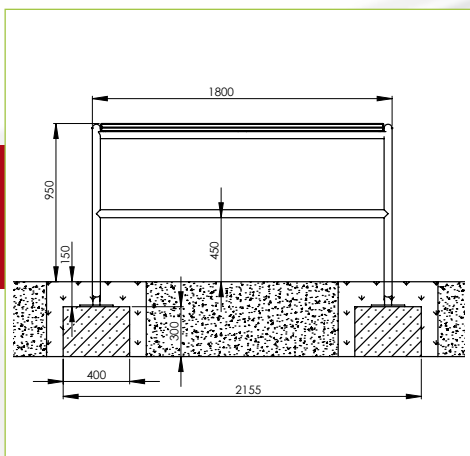
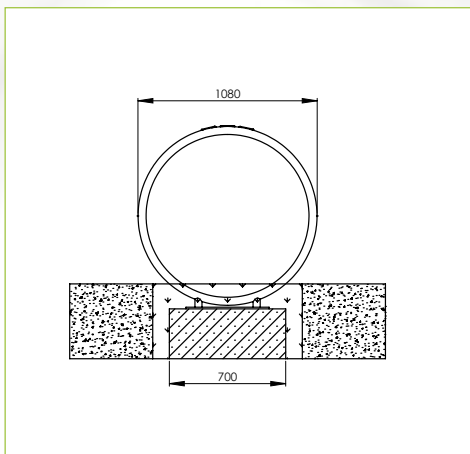

Bench "primus"

Stainless steel
with hardwood as seat

Item No. 57 1050 401

(LxBxH) Equipment
dimensions

1800 x 1080 x 950 mm

Height of seat

500 mm

Recommended surface
material

optional

All rights and product modifications reserved.

Barstool "decos ilex"

Stainless steel
with hardwood as table top

Item No. 57 1525 401

(LxBxH) Equipment
dimensions

430 x 470 x 843 mm

Height of seat

840 mm

Recommended surface
material

optional

All rights and product modifications reserved.

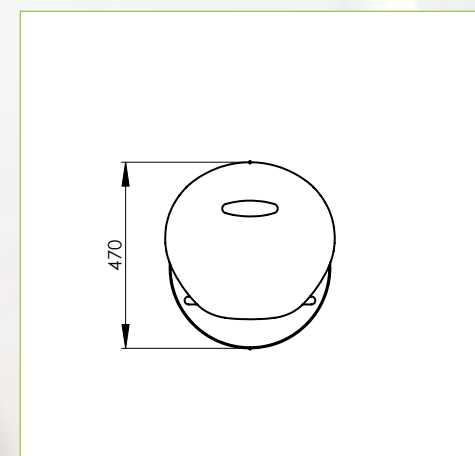
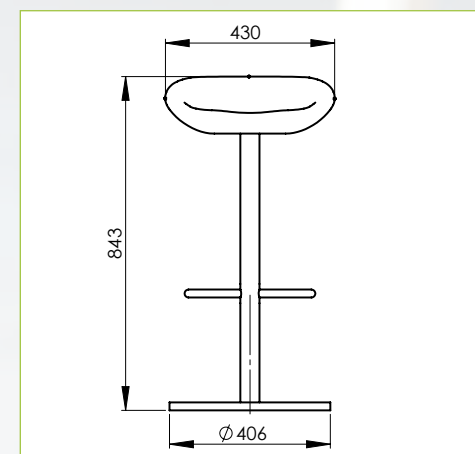



Meeting in a relaxed atmosphere, start talking with each other – the stilum bar "ligna" promotes communication.



Bar "ligna"

Stainless steel with hardwood as table top	Item No. 57 1522 401
(LxBxH) Equipment dimensions	3000 x 720 x 1100 mm
optional(LxBxH) also available	4160 x 760 x 1100 mm
Height of table	1100 mm
Recommended surface material	optional
All rights and product modifications reserved.	

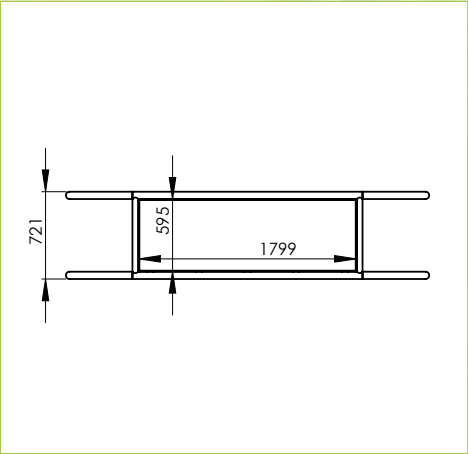
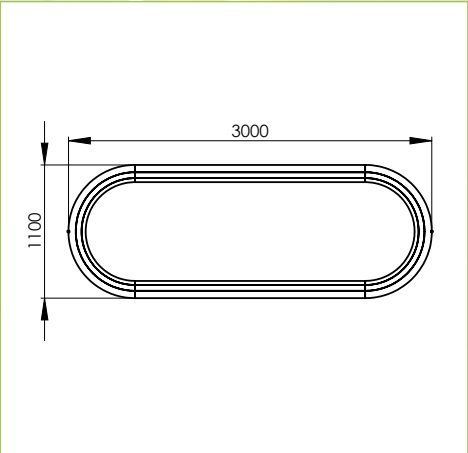



*stilum creates products for
feeling comfortable.*



Suite "decos"

table "decos"

Stainless steel
with hardwood as table top

Item No. 57 1523 401

(LxBxH) 1645 x 1097 x 560 mm

Height of table 560 mm

Recommended surface
material optional

All rights and product modifications reserved.

"chair "decos sella"

Stainless steel and hardwood

Item No. 57 1524 401

(LxBxH) Equipment
dimensions 850 x 500 x 1100 mm

Height of seat 500 mm

Recommended surface
material optional

All rights and product modifications reserved.

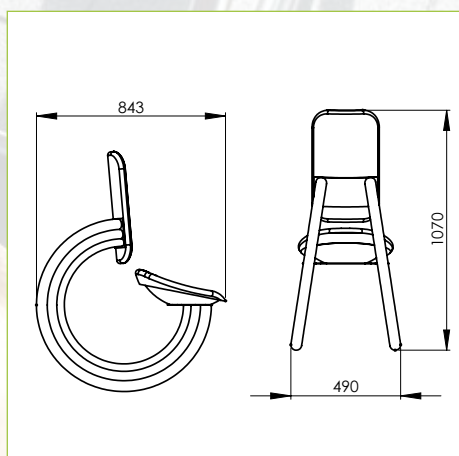
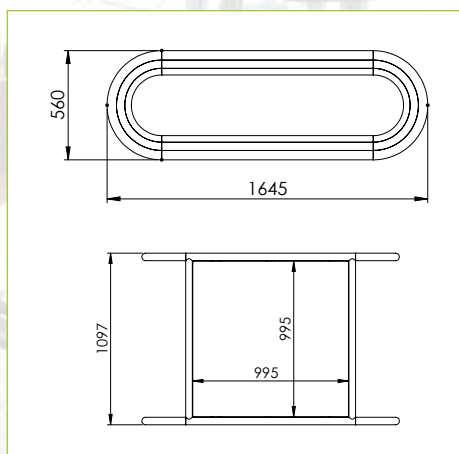



Ideal when it comes to disposal of urban waste, i.e. waste disposal systems by stilum.

Elegantly shaped and practical, they upgrade any inner-city or park area.

papyrus1	36
papyrus2 + papyrus5	37
papyrus5 Holz	38
papyrus5 Wood	
cinis1 + cinis 2	39

The elegantly shaped waste containers by stilum upgrade any public area.

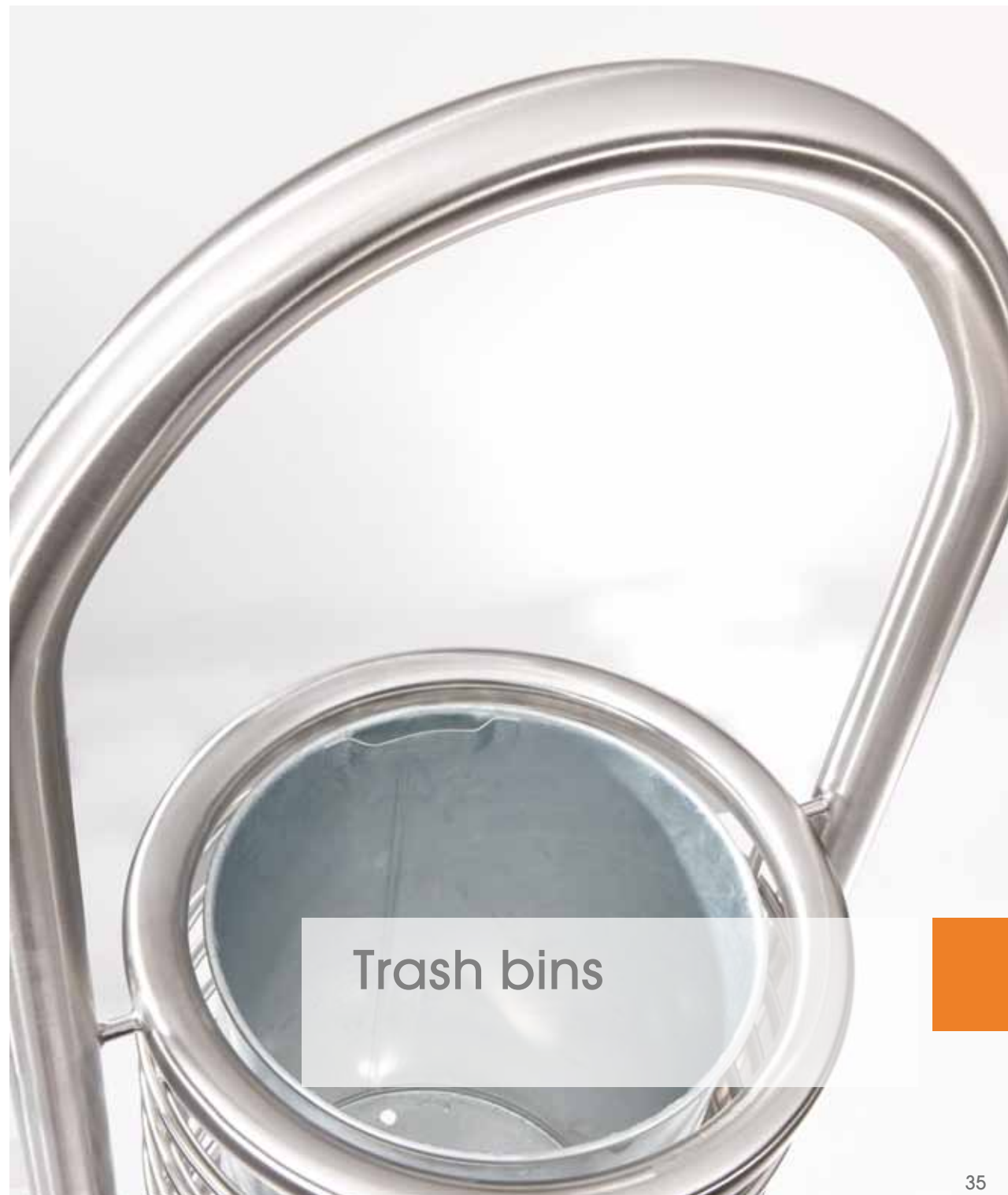

Trash bins

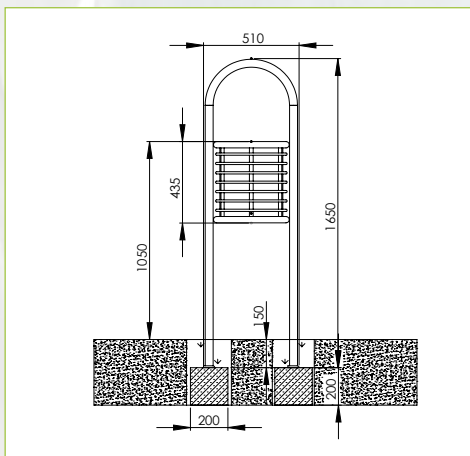
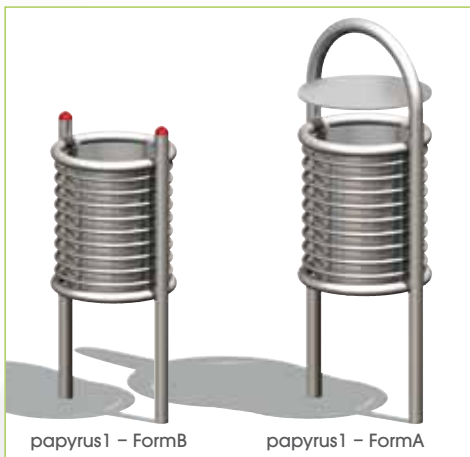

Litter bin "papyrus1"

papyrus1 – FormA	Item No. 57 3020 401
Stainless steel	
papyrus1 – FormB	Item No. 57 3020 402
Stainless steel	
(LxBxH) Equipment dimensions	400 x 510 x 1500 mm
Recommended surface material	optional
Volume	30 l
Weight	30 kg
Cover plate for papyrus1 Form A optional	
All rights and product modifications reserved.	

Litter Bin "papyrus2"

papyrus2 – FormA

Item No. 57 3021 401

Stainless steel

papyrus2 – FormB

Item No. 57 3021 402

Stainless steel

(LxBxH) Equipment dimensions

400 x 500 x 1500 mm

Recommended surface material

optional

Volume

30 l

Weight

30 kg

Cover plate for papyrus2 Form A optional

All rights and product modifications reserved.

Litter bin "papyrus5"

papyrus5 – FormA

Item No. 57 3025 401

Stainless steel

papyrus5 – FormB

Item No. 57 3025 402

Stainless steel

(LxBxH) Equipment dimensions

400 x 495 x 1500 mm

Recommended surface material

optional

Volume

30 l

Weight

30 kg

Cover plate for papyrus5 Form A optional

All rights and product modifications reserved.

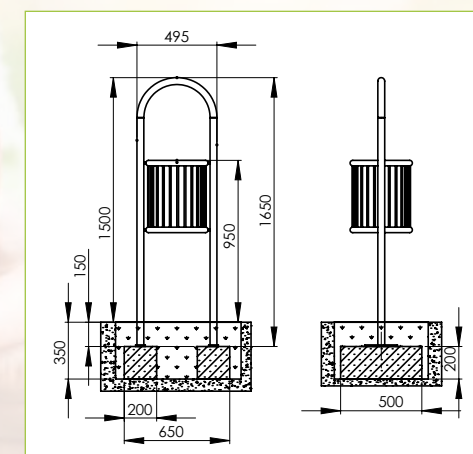
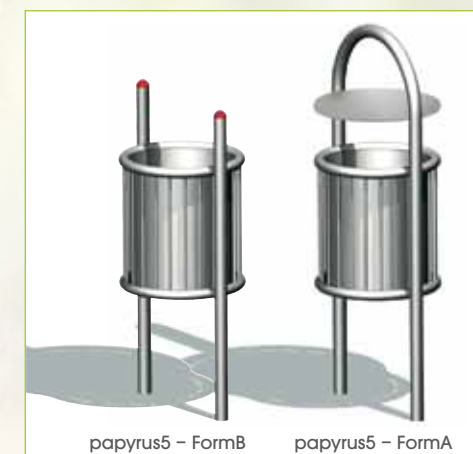
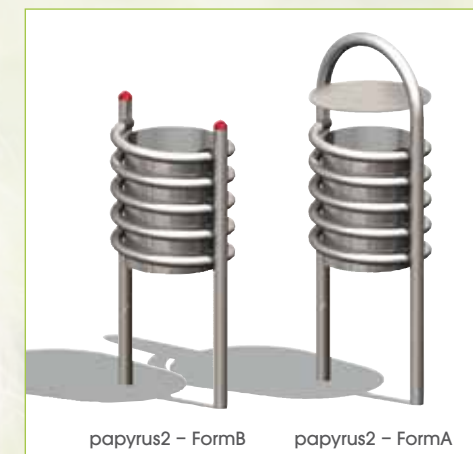

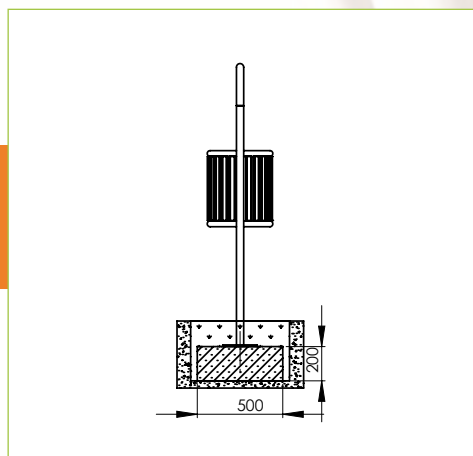
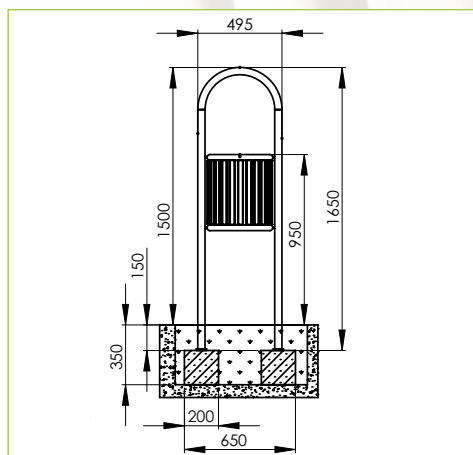

Litter bin "papyrus5" (Wood)

Item No. 57 3025 403

Stainless steel
in combination with hardwood

(LxBxH) Equipment dimensions 400 x 495 x 1500 mm

Recommended surface material optional

Volume 30 l

Weight 30 kg

All rights and product modifications reserved.

Ash tray "cinis1"

Stainless steel	Item No. 57 3030 401
(LxBxH) Equipment dimensions	Ø 180 x 220 x 1025 mm
Recommended surface material	optional
Volume	500 ml
Weight	auf Anfrage on request

The ash-tray can also be erected with all papyrus litter bins.

All rights and product modifications reserved.

Ash tray "cinis2"

Stainless steel	Item No. 57 3031 401
(LxBxH) Equipment dimensions	Ø 180 x 220 x 1025 mm
Recommended surface material	optional
Volume	500 ml
Weight	auf Anfrage on request

The ash-tray can also be erected with all papyrus litter bins.

All rights and product modifications reserved.

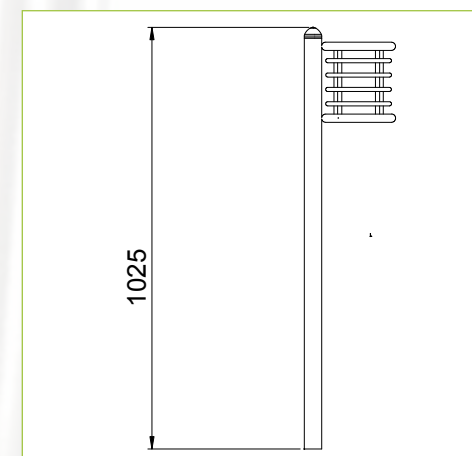



The delicately designed bus shelter "mantus" appeals by its elegantly curved shape which gives it a friendly image hard to resist.

Well protected against wind and weather, it offers all the shelter and seating comfort for a minimum of eight people that you can wish for. Be it roofed or unroofed, the bench "mantus" is always a convincingly good idea for the urban requirements of our society.

An elegant up-grade of your waiting areas – unmistakably stilum!

*The bus shelter by stilum
upgrades any public waiting area.*



Waiting area



The bus shelter "mantus" combines practical shelter against the weather with an appealing design.



Bus shelter "mantus"

Stainless steel
in combination with hardwood

Item No. 57 6500 401

(LxBxH) Equipment
dimensions

3180 x 2111 x 2550 mm

Recommended surface
material

optional

Installation depth

150 mm

All rights and product modifications reserved.

>> TIP

Bus shelter, coaching bench etc.

– "mantus" is universal in use!

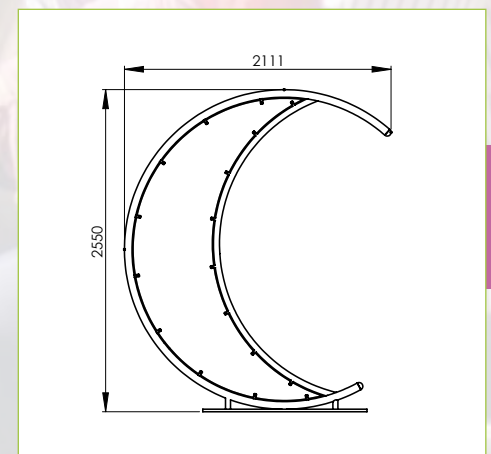
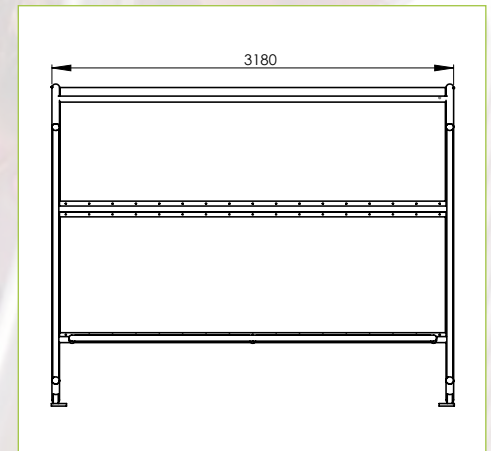



Modelled on the design of old Morse lamps, the two spotlights "lumos" come along in an extremely solid construction made of softly gleaming stainless steel.

Held by a compact U-bow, the lamp head can be turned up and down drawing spectacular attention to your object.

The glass cover is fastened by means of a screwed ring and the solid tripod prevents the lamp from collapsing.

lumos1	46
lumos2	47
coma	48
Ennos-m/k	49

*Lightning by stilum
sets shining accents.*

Illumination

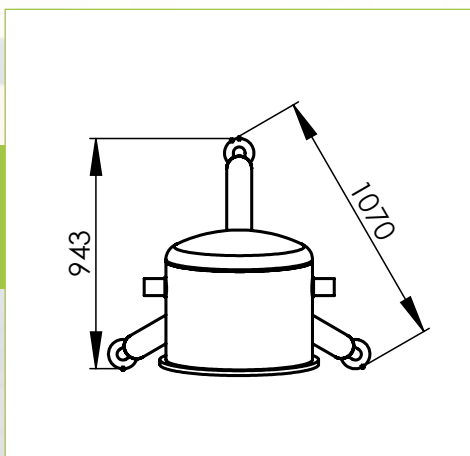
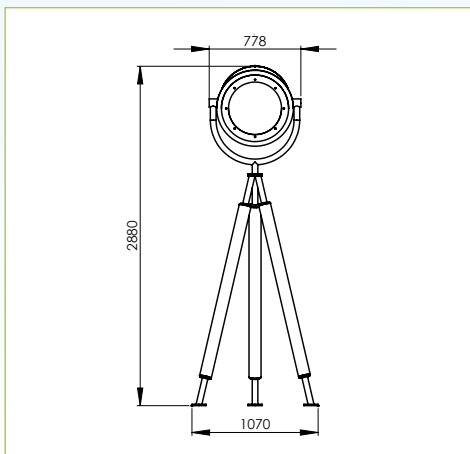

Spot light "lumos1"

Stainless steel

Item No. 57 6010 401

(LxBxH) Equipment
dimensions

triangle rack 1070 x 1070 x 1070 mm

Spot (adjustable) Ø 778 mm

Total height 2880 mm

15 W energy saving lamp, other lightnings on request

Recommended surface
material

optional

All rights and product modifications reserved.

Spot light "lumos2"

Stainless steel

Item No. 57 6010 402

(LxBxH) Equipment
dimensions

Spot (adjustable)
Ø 810 x 600 mm

Total height 750 mm

15 W energy saving lamp, other lightnings on request

Recommended surface
material

optional

All rights and product modifications reserved.

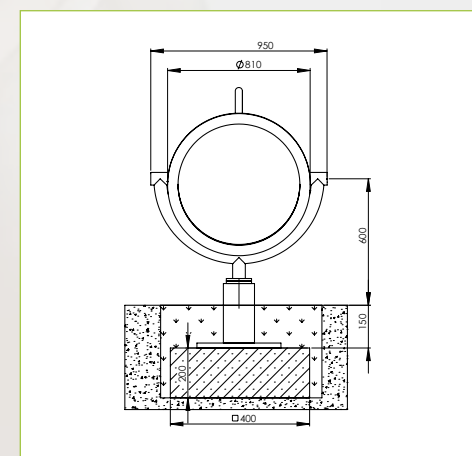

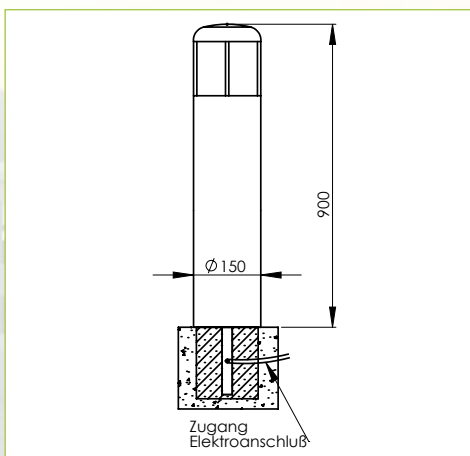

Illuminating bollard "coma"

Coloured rubber granule

Item No. 25 3788 101

(LxBxH) Equipment
dimensions

Ø 150 x 900 mm

15 W energy saving lamp, other lightnings on request

Lamp placed in case made of plastic with a covering made of stainless steel

Recommended surface
material

optional

All rights and product modifications reserved.

Illuminating bollard "Ennos-m/k"

Stainless steel	Item No. 57 5010 401
(LxBxH) Equipment dimensions	Ø 154 x 620 mm
Available with frosted plexiglass or clear plexiglass with two anti-dazzle rings	
Weight	6 kg
Recommended surface material	optional
All rights and product modifications reserved.	

3p  Technologie

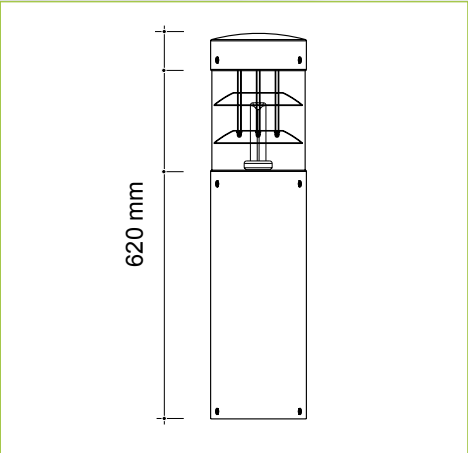

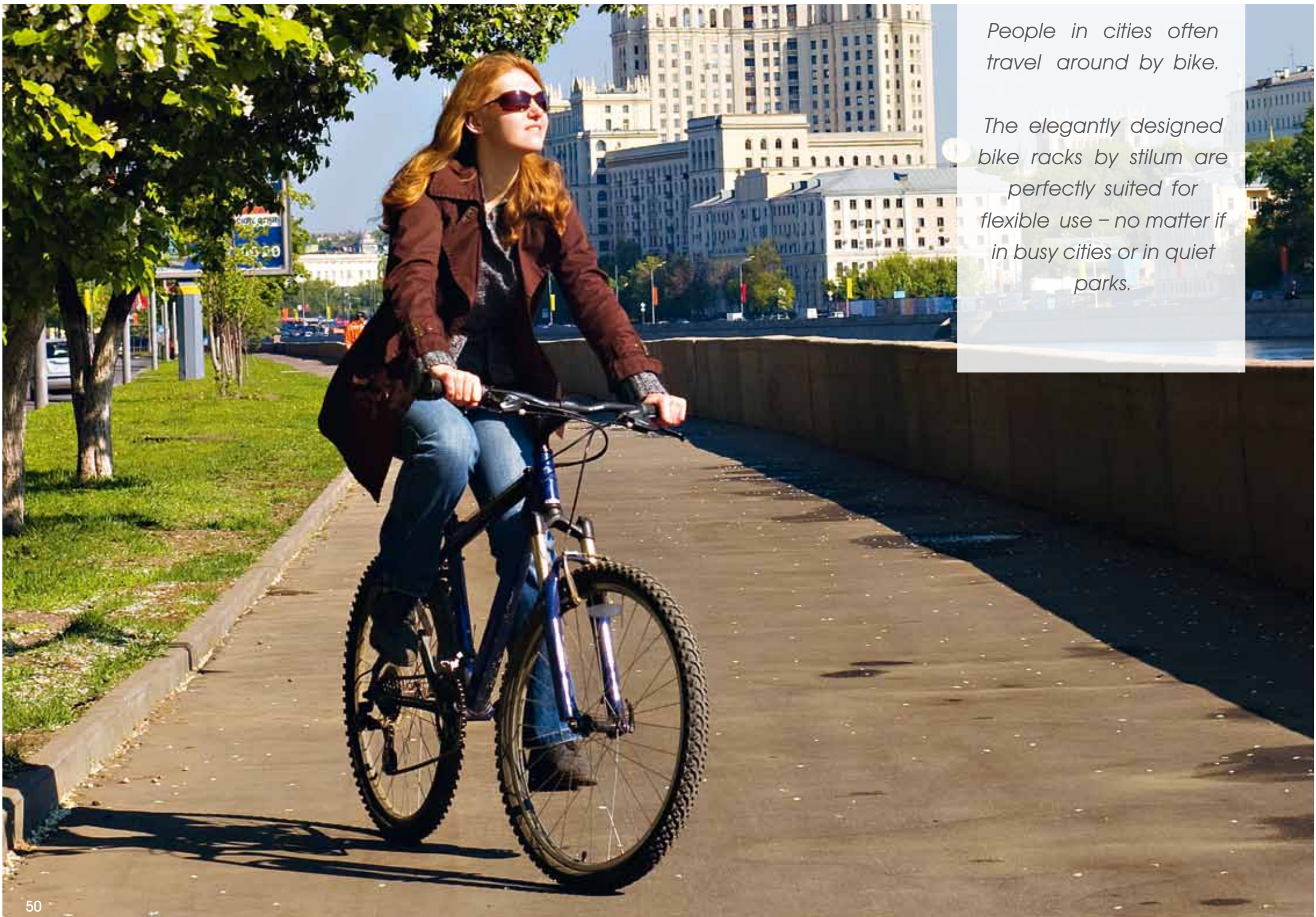

People in cities often travel around by bike.

The elegantly designed bike racks by stilum are perfectly suited for flexible use – no matter if in busy cities or in quiet parks.

persto	52
alligo	53
insisto	54
cogo	55
signum1	56
sciro1	57
sciro2	58
signum2	59

*Bike racks by stilum
harmoniously fit in with
city and park.*

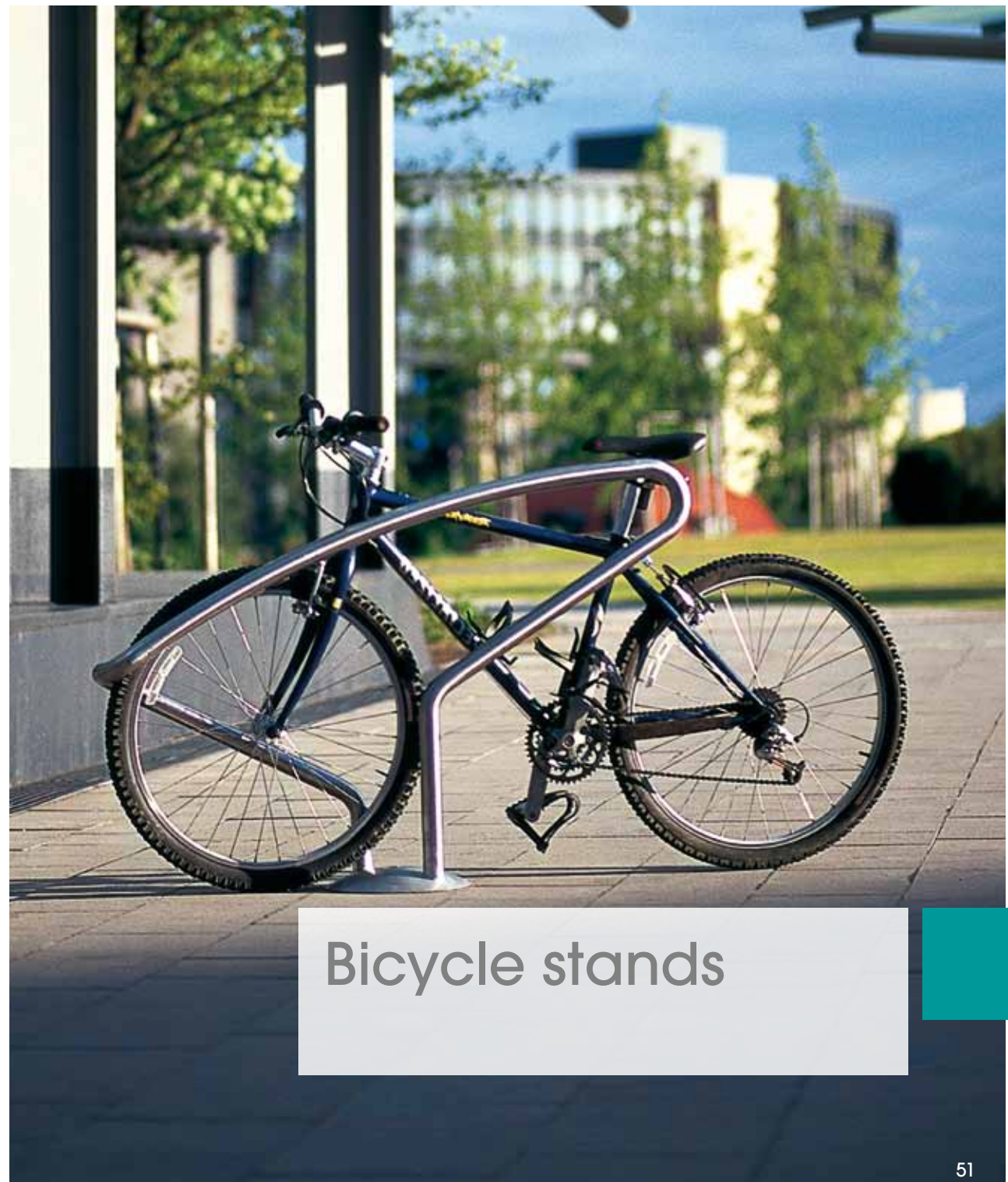

Bicycle stands

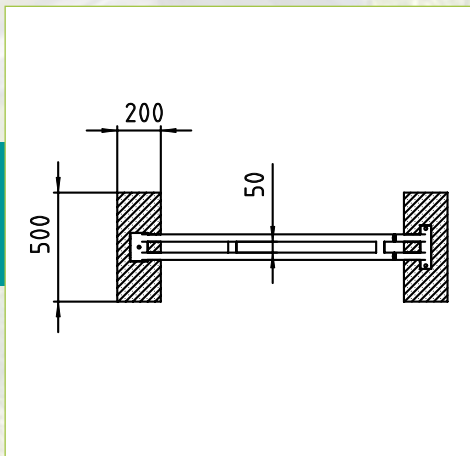
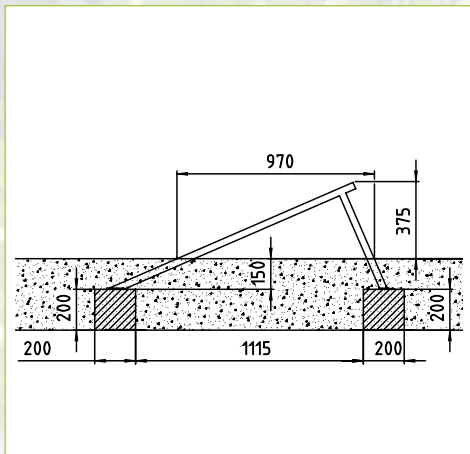

Bicycle stand "persto"

Stainless steel

Item No. 57 2513 401

(LxBxH) Equipment dimensions

970 x 120 x 375 mm

Recommended surface material

optional

Installation depths

0 mm/150 mm

2 concrete foundations

500 x 200 x 200 mm

Heaviest piece

18 kg

Longest piece

1400 mm

All rights and product modifications reserved.

Bicycle stand "alligo"

Stainless steel

Item No. 57 2512 401

(LxBxH) Equipment dimensions

1280 x 50 x 920 mm

Recommended surface material

optional

Installation depths

0 mm/150 mm

2 concrete foundations

1000 x 200 x 200 mm

Heaviest piece

15 kg

Longest piece

1650 mm

All rights and product modifications reserved.

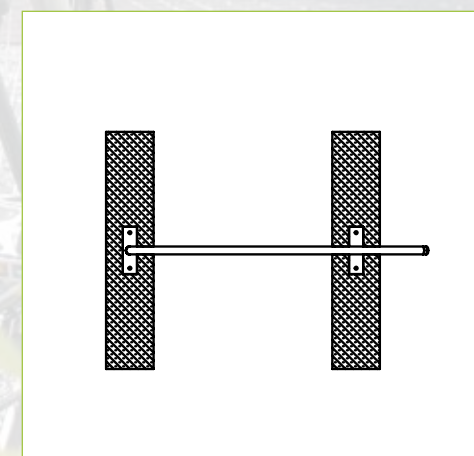
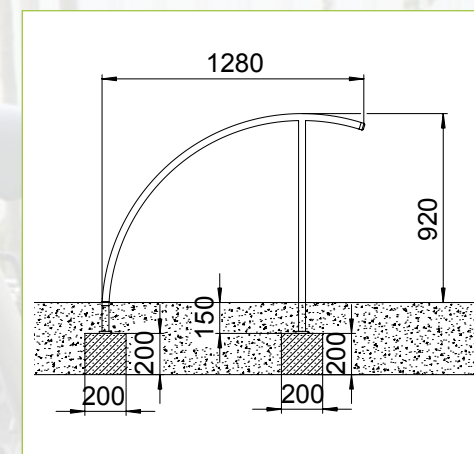

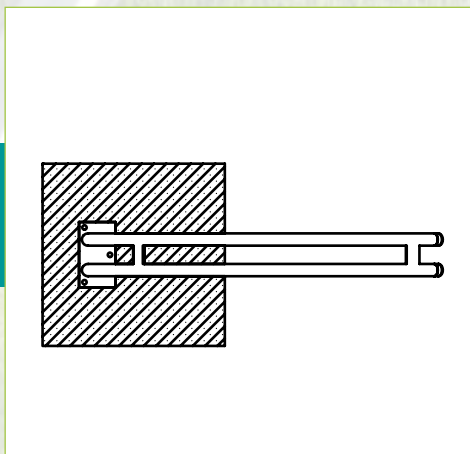
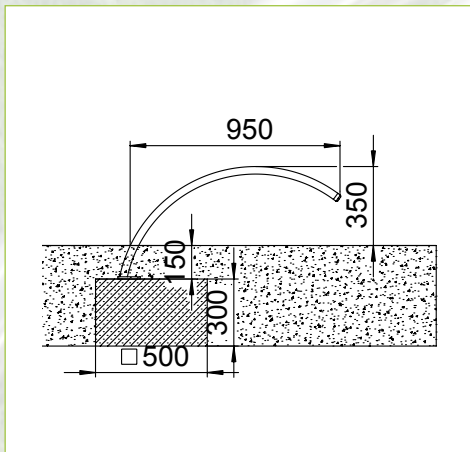

Bicycle stand "insisto"

Stainless steel

Item No. 57 2511 401

(LxBxH) Equipment dimensions

950 x 120 x 350 mm

Recommended surface material

optional

Installation depths

0 mm/ 150 mm

1 concrete foundation

500 x 500 x 300 mm

Heaviest piece

15 kg

Longest piece

1050 mm

All rights and product modifications reserved.

Bicycle stand "cogo"

Stainless steel	Item No. 57 2514 401
(LxBxH) Equipment dimensions	835 x 50 x 800 mm
Recommended surface material	optional
Installation depths	0 mm/150 mm
2 concrete foundations	800 x 200 x 200 mm
Heaviest piece	15 kg
Longest piece	835 mm

All rights and product modifications reserved.

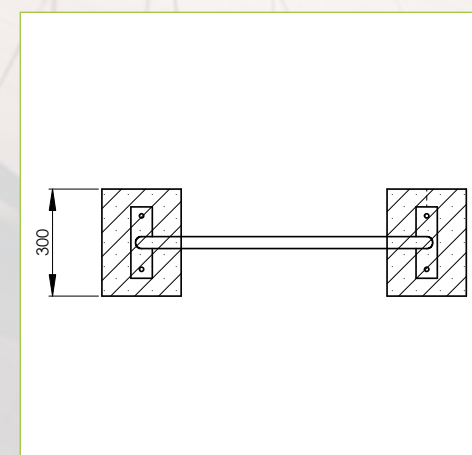
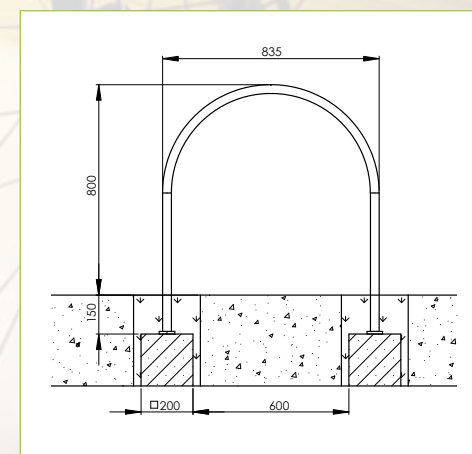

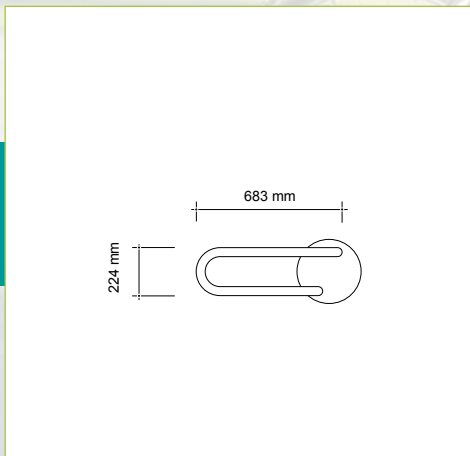
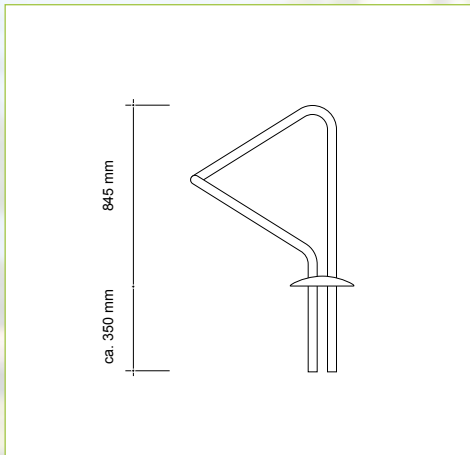

Bicycle stand "signum1"

Stainless steel	Item No. 57 2515 401
(LxBxH) Equipment dimensions	683 x 224 x 845 mm
Recommended surface material	optional
Installation depth 1	350 mm
Heaviest piece	8 kg
Longest piece	1195 mm

All rights and product modifications reserved.

Bicycle stand "sciro1"

Stainless steel

Item No. 57 2517 401

(LxBxH) Equipment dimensions

1685 x 500 x 911 mm

Recommended surface material

optional

Installation depth 1

150 mm

weight

12 kg

Longest piece

1685 mm

All rights and product modifications reserved.

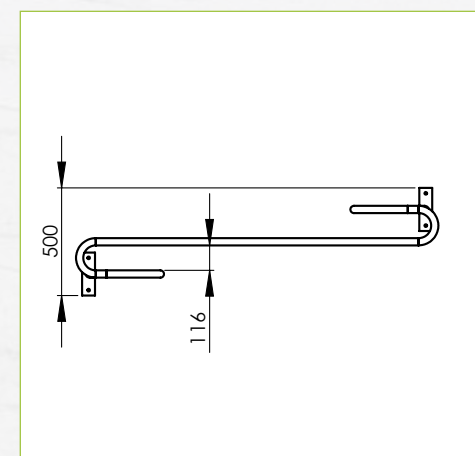
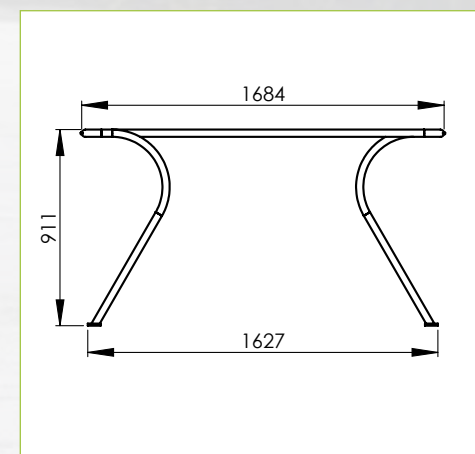

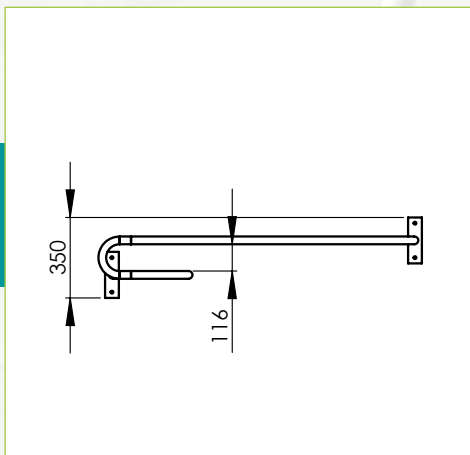
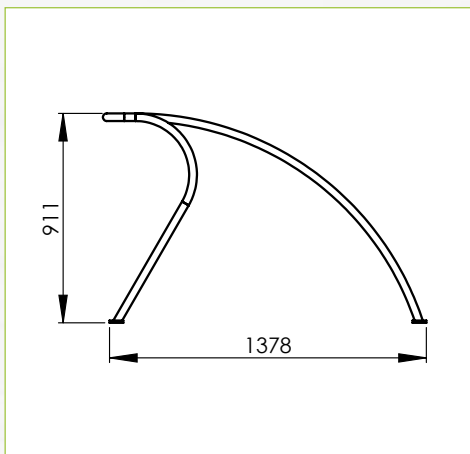

Bicycle stand "sciro2"

Stainless steel	Item No. 57 2518 401
(LxBxH) Equipment dimensions	1380 x 350 x 911 mm
Recommended surface material	optional
Installation depth 1	150 mm
weight	12 kg
Longest piece	1380 mm

All rights and product modifications reserved.

Bicycle stand "signum2"

Stainless steel	Item No. 57 2516 401
(LxBxH) Equipment dimensions	1240 x 224 x 845 mm
Recommended surface material	optional
Installation depth 1	350 mm
Heaviest piece	10 kg
Longest piece	1195 mm

All rights and product modifications reserved.

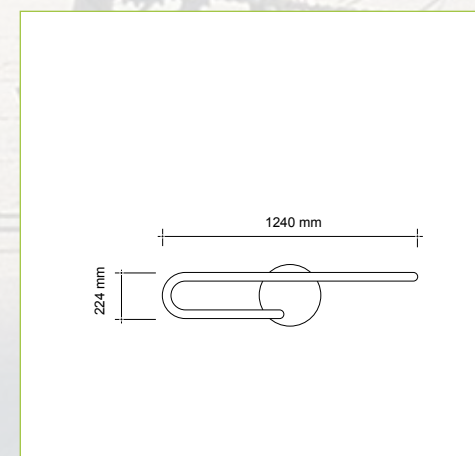
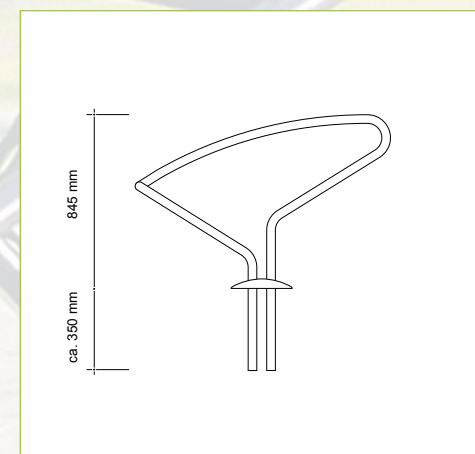



These advertising media drop out of the common optics and underline the effect of your bills.

With its banners, sails and picture frames, stilum keeps its promise of combining functionality with an appealing design.

The advertising media for outdoor areas are resistant to weather and suited for permanent use.

You frequently present new things at fairs and exhibitions? Why not simply change the contents? The frame remains the same.

opaco	62
umbro	63
signifer1	64
signifer2	65
margino	66
specto	67

The banners, sails and picture frames by stilum combine functionality with an appealing design.



Media vehicles & shadowing elements



Sun sail "opaco"

Also in our quite moderate latitudes we feel the effects of progressing climatic changes.

Impacts of aggressive UV-radiation are on the rise, but stilum has the solution for you!

We have developed a flexible sun sail which can be rolled up if requested.

Please feel free to ask for more details of our innovative products!

Sun sail "umbro"

Enjoying the sun and escaping it at the same time: experience the new summer feeling with sun sails by stilum!

Either as a firmly installed element for permanent shadowing in the garden or as a flexible and temporarily usable triangle sail which can be rolled up if necessary – stilum help you to create a completely new qua-lity of life in your garden!

Don't hesitate to ask, without any commitment, for your tailor-made sun sail "umbro" by stilum!



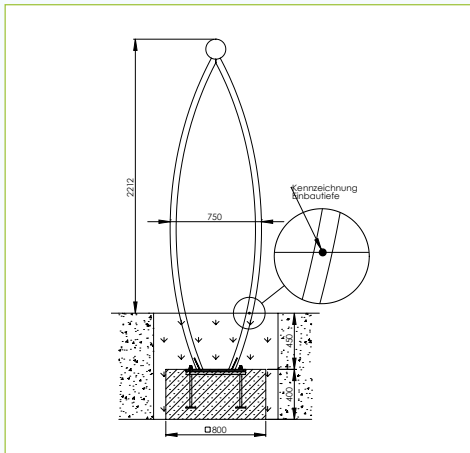

Banner "signifer1"

Stainless steel	Item No. 57 5511 401
(LxBxH) Equipment dimensions	760 x 420 x 2212 mm
Recommended surface material	optional
Installation depth	150 mm also available with pedestal
Foundations	concrete foundation 500 x 200 x 200 mm

All rights and product modifications reserved.

Banner "signifer2"

Stainless steel	Item No. 57 5512 401
(LxBxH) Equipment dimensions	1161 x 420 x 3276 mm
Recommended surface material	optional
Installation depth	150 mm also available with pedestal
Foundations	concrete foundation 500 x 200 x 200 mm

All rights and product modifications reserved.

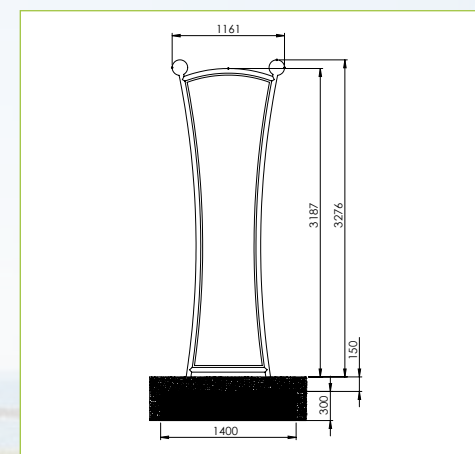



Picture frame "margino"

Stainless steel Item No. 57 5515 401

(LxBxH) Equipment dimensions 437 x 993 x 1479 mm

Recommended surface material optional

Installation depth 1 0 mm

Fundamente Foundations --

All rights and product modifications reserved.

Other sizes on request

Showcase "specto"

Aluminium	Item No. 57 5510 501
(LxBxH) Equipment dimensions	1700 x 80 x 1900 mm
Recommended surface material	optional
Installation depth 1	0 mm
Installation depth 2	150 mm

Foundations 2 concrete foundations

All rights and product modifications reserved.

Other sizes on request

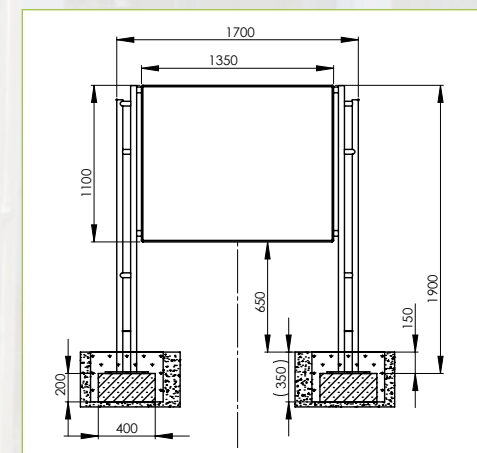



*When cities awake, people
liven up and it gets loud.*

*In places where these
sounds become rampant
the noise-protection
module "sonito" is able to
absorb up to 32 decibels of
the sound emission.*

*Be it on highly frequented
roads, as flexible and mobile
demarcation walls for
temporary activities in public
spaces or as sound and
privacy shields in private
outdoor areas – "sonito"
is fast and easy to install,
comes at an attractive
price and requires an
extremely low level of
maintenance.*

sonito	70
saepes	71

Sound and privacy shields by stilum are flexible, mobile and impress by their high-quality optics.

Noise absorbing walls
& visual protection



Not only traffic noise but also annoying noises from your neighbours can be absorbed by the noise-protection systems.



Sound insulating wall "sonito"

1. Coloured rubber granule	Item No. 58 1000 101
2. Coloured rubber granule	Item No. 58 1100 101
1. (LxHxB) Equipment dimensions	2000 x 500 x 100 mm /element
1. Item No. 58 1000 101	
2. (LxHxB) Equipment dimensions	1800 x 600 x 80 mm / Element
2. Item No. 58 1100 101	
Colors	redbrwn, green, anthracite
Recommended surface material	optional
Installation depth	optional
Foundations	optional
Sound absorption	8 – 11 db belonging to the wall thickness
lateral fixation	optional
T-bar	t-bar, galvanized steel, cover plate made of stainless steel optional

All rights and product modifications reserved.

Visual protection "saepes"

Stainless steel	Item No. 58 1010 401
(LxBxH) Equipment dimensions	1400 x 70 x 1865 mm
Recommended surface material	optional
Installation depth	150 mm
Foundations	belongs to the construction
All rights and product modifications reserved.	

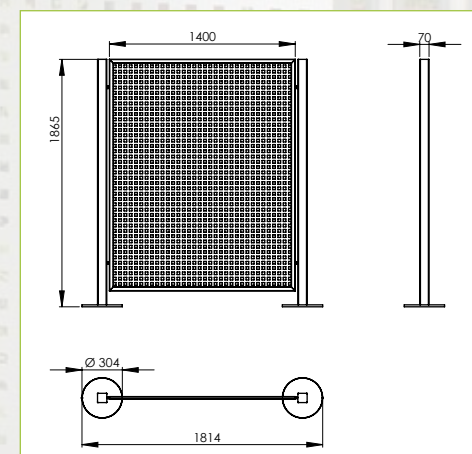



Balls and cubes are shapes which cannot be improved. Made of high-quality rubber granulate, they serve as attractive seating furniture, as impact-absorbing play elements or as exceptional margin stops.

In addition, they are extremely solid. Thanks to the flexible rubber granulate, the boundary post "postis" is an ideal element for driveways and path boundaries. "postis" will not bend out of shape when slightly touched.

globus	74
quadro	75
postis	76 – 77

The design elements made of high-quality rubber granulate are extremely stable and require only a low level of maintenance.

A young girl with brown hair, wearing a headband with white daisies and a blue patterned dress, is smiling and leaning over a large, textured spherical playground element. The sphere is primarily orange with a red band. The background is a soft-focus outdoor setting.

Design elements

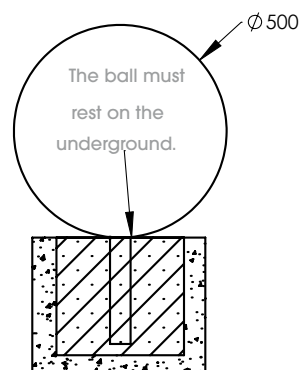

Bowl "globus"

Coloured rubber granule

Item No. 35 3350 101

(LxBxH) Equipment
dimensions

Ø 500 mm | Ø 400 mm | Ø 300 mm

Floor anchor

inclusive

Recommended surface
material

optional

Colours

redbrown, green, anthracite, EPDM

All rights and product modifications reserved.

Cube "quadro"

Coloured rubber granule	Item No. 35 3240 101
(LxBxH) Equipment dimensions	400 x 400 x 400 mm
Floor anchor	optional
Recommended surface material	optional
Colours	redbrown, green, anthracite, silvergrey

All rights and product modifications reserved.

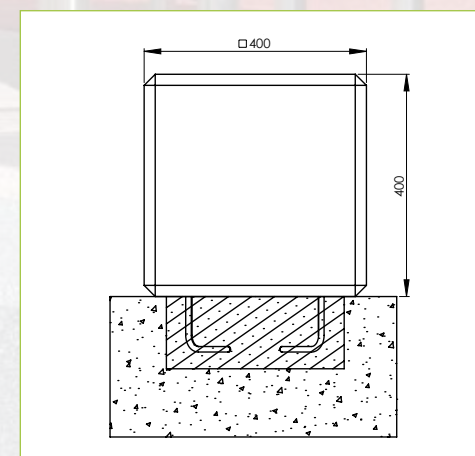



The boundary post "postis" will not bend out of shape when slightly touched.



Boundary post "postis"

Coloured rubber granule

Item No. 25 3660 101

(LxBxH) Equipment
dimensions

Ø 200 x 600/900 mm

Recommended surface
material

optional

with floor anchor

Chain fastening

optional

Colours

redbrown, green, anthracite,
silvergrey

All rights and product modifications reserved.

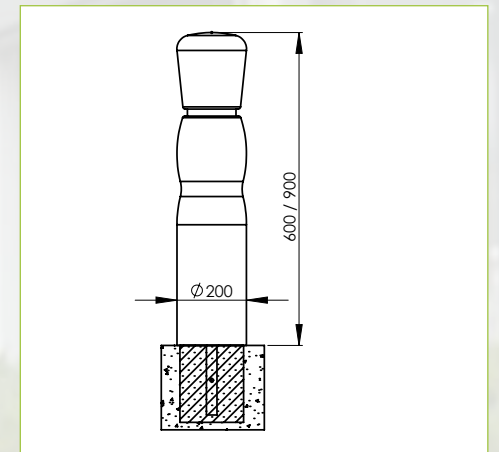



With their tall, slim shape, vases by stilum are an eye-catcher for any indoor or outdoor area. They are available in six different colours ranging from matt red-brown to metallic shining gold. In these vases, both modern pu-ristic and opulent flower arrangements are turned into over-all works of art.

The high-quality material allows for arrangements varying in height and shape and, as easy as anything, meets any demand for design.

arundo	80 – 81
cylindrus	82 – 83
linea	84 – 85
ollaris	86
camella	87

*Vases made of rubber granulate –
an appealing design and
high-quality materials guarantee
long-lasting aesthetic appearance.*



Vases



Its organic shape and the metal ring make the vase "arundo" look very noble.



Vase "arundo" 500/750/1000

Coloured rubber granule

Item No. 35 3200 101 (arundo1000 rot)

Item No. 35 3200 103 (arundo750 rot)

Item No. 35 3200 104 (arundo500 rot)

(LxBxH) Equipment dimensions

Ø 600 – 450 x 500 mm (arundo500)

Ø 600 – 450 x 750 mm (arundo750)

Ø 600 – 450 x 1000 mm (arundo1000)

Colours

red, green, anthracite

beige, silver, metallic, purple, gold

Recommended
surface material

optional

Base plate for stabilization optional

Decoration ring made of stainless steel or brass

optional

All rights and product modifications reserved.





Vases made of rubber granulate by stilum are resistant to extreme variations in temperature.



Vase "cylindrus" 500/750/1000

Coloured rubber granule	Item No. 35 3400 101 (cylindrus1000 rot)
	Item No. 35 3400 103 (cylindrus750 rot)
	Item No. 35 3400 104 (cylindrus500 rot)

(LxBxH) Equipment dimensions	Ø 500 x 500 mm (cylindrus500)
	Ø 500 x 750 mm (cylindrus750)
	Ø 500 x 1000 mm (cylindrus1000)

Colours red, green, anthracite
beige, silver, metallic, purple, gold

Recommended surface material	optional
------------------------------	----------

Glass top made of frosted glass optional

All rights and product modifications reserved.





The clear geometric shape of the vase "linea" is the perfect complement to modern, puristic architecture.



Vase "linea" 500/750/1000

Coloured rubber granule Item No. 35 3500 101 (linea1000 rot)
ItemNo. 35 3500 103 (linea750 rot)
Item No. 35 3500 104 (linea500 rot)

(LxBxH) Equipment dimensions 500 x 500 x 500 mm (linea500)
500 x 500 x 750 mm (linea750)
500 x 500 x 1000 mm (linea1000)

Colours red, green, anthracite
beige, silver, metallic, purple, gold

Recommended surface material optional

All rights and product modifications reserved.





Garden trough "ollaris"

Coloured rubber granule

Item No. 35 3100 101 (ollaris rot)

(LxBxH) Equipment
dimensions

Ø 550 x 500 mm

Colours

red, green, anthracite
beige, silver, metallic, purple, gold

Recommended
surface material

optional

All rights and product modifications reserved.

Vase "camella"

Coloured rubber granule Item No. 35 3701 101 (camella rot)

(LxBxH) Equipment
dimensions Ø 400/140 x 500 mm

Colours red, green, anthracite
beige, silver, metallic, purple, gold

Recommended
surface material optional

All rights and product modifications reserved.



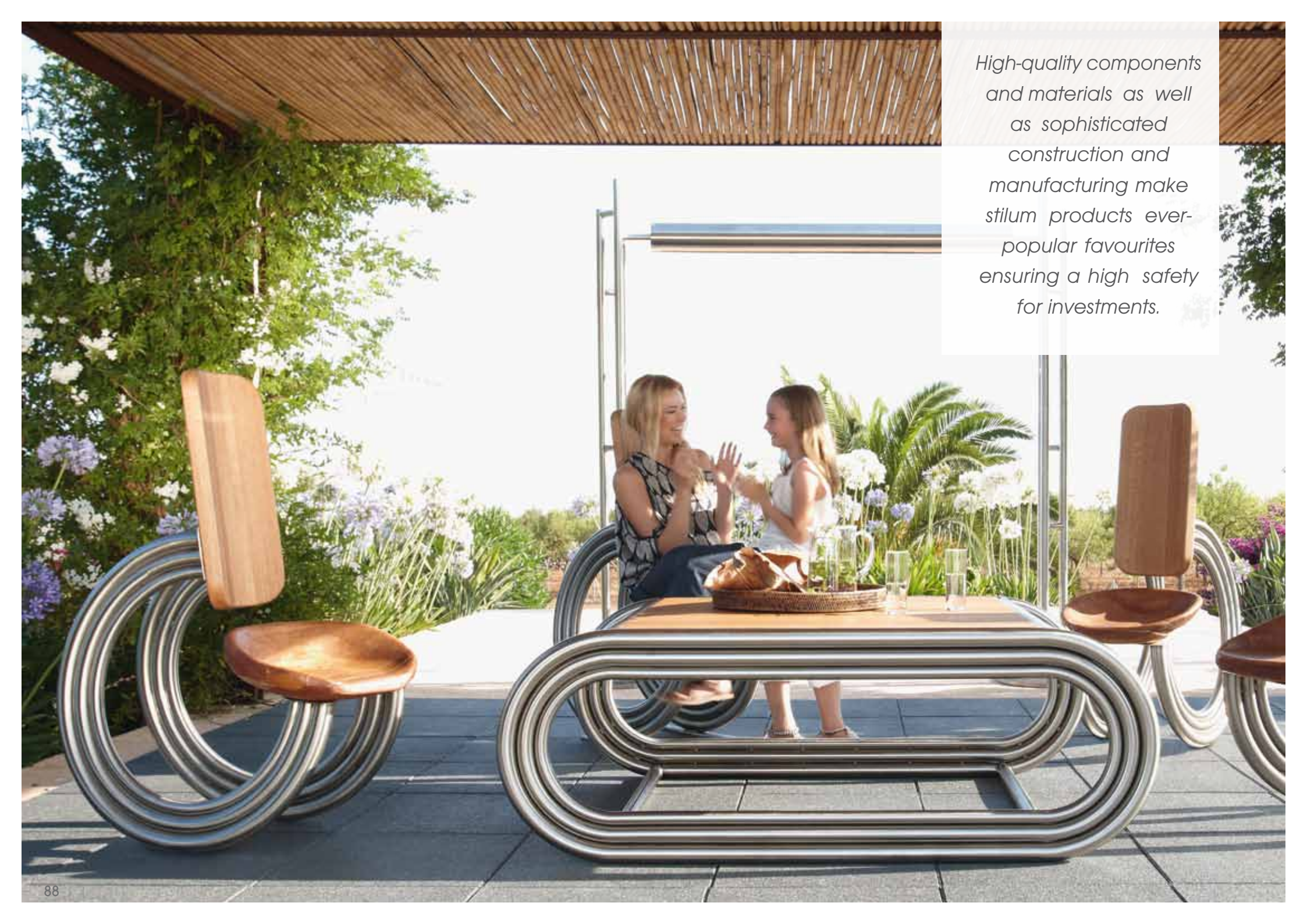

*High-quality components
and materials as well
as sophisticated
construction and
manufacturing make
stilum products ever-
popular favourites
ensuring a high safety
for investments.*

**Cost-effective as regards price,
performance and maintenance**

stilum products are competitively priced in the market place. Your reassurance comes with High quality manufacturing techniques that ensure the minimum maintenance is required.

For the safety of the children: EN 1176

stilum play equipment is certified throughout the EU and is delivered with safety certificate:

It gives you the guarantee that stilum play equipment meets the latest European safety standards.



Technical information



Custom-made equipment



stilum warranty



Replacement parts

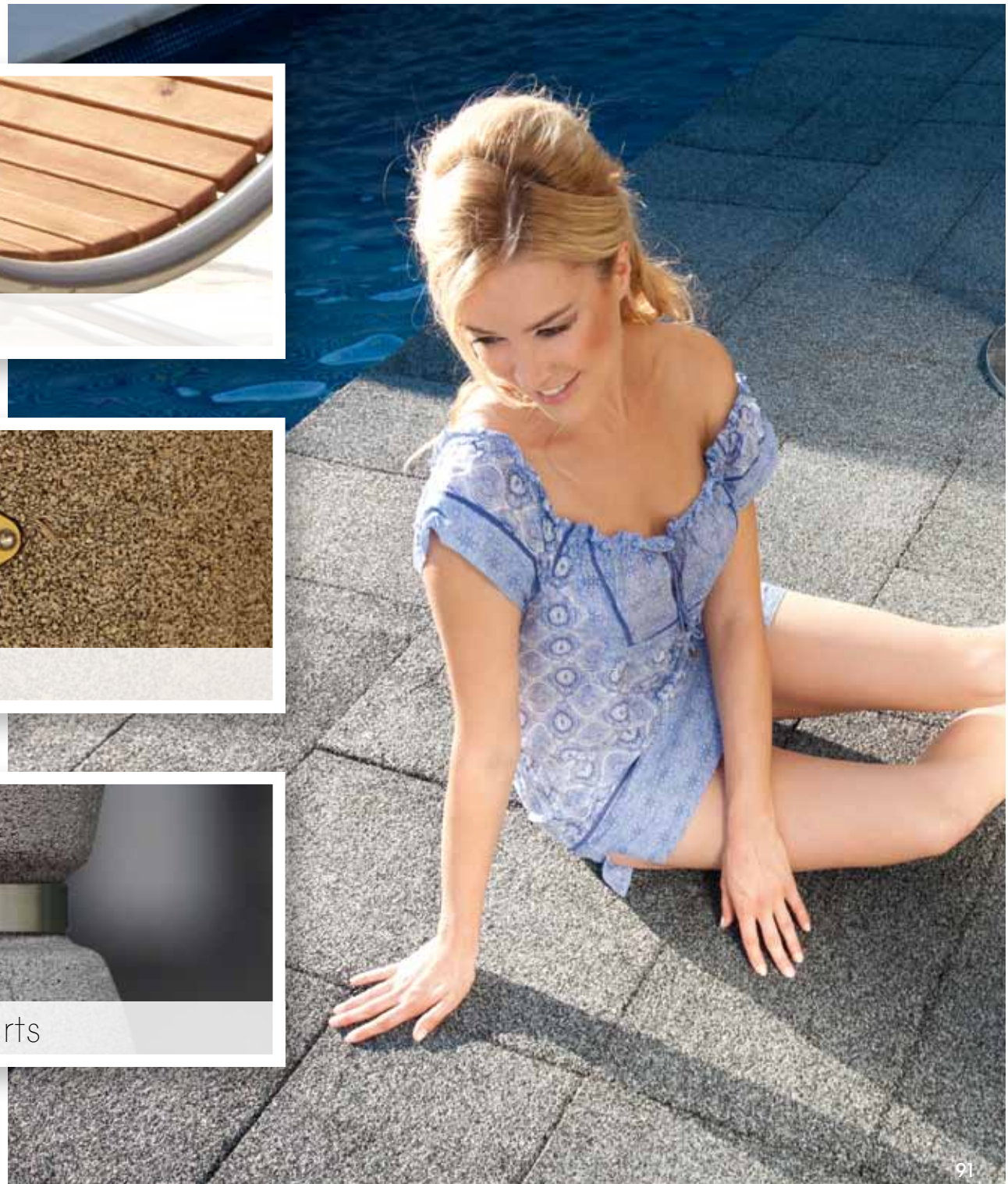

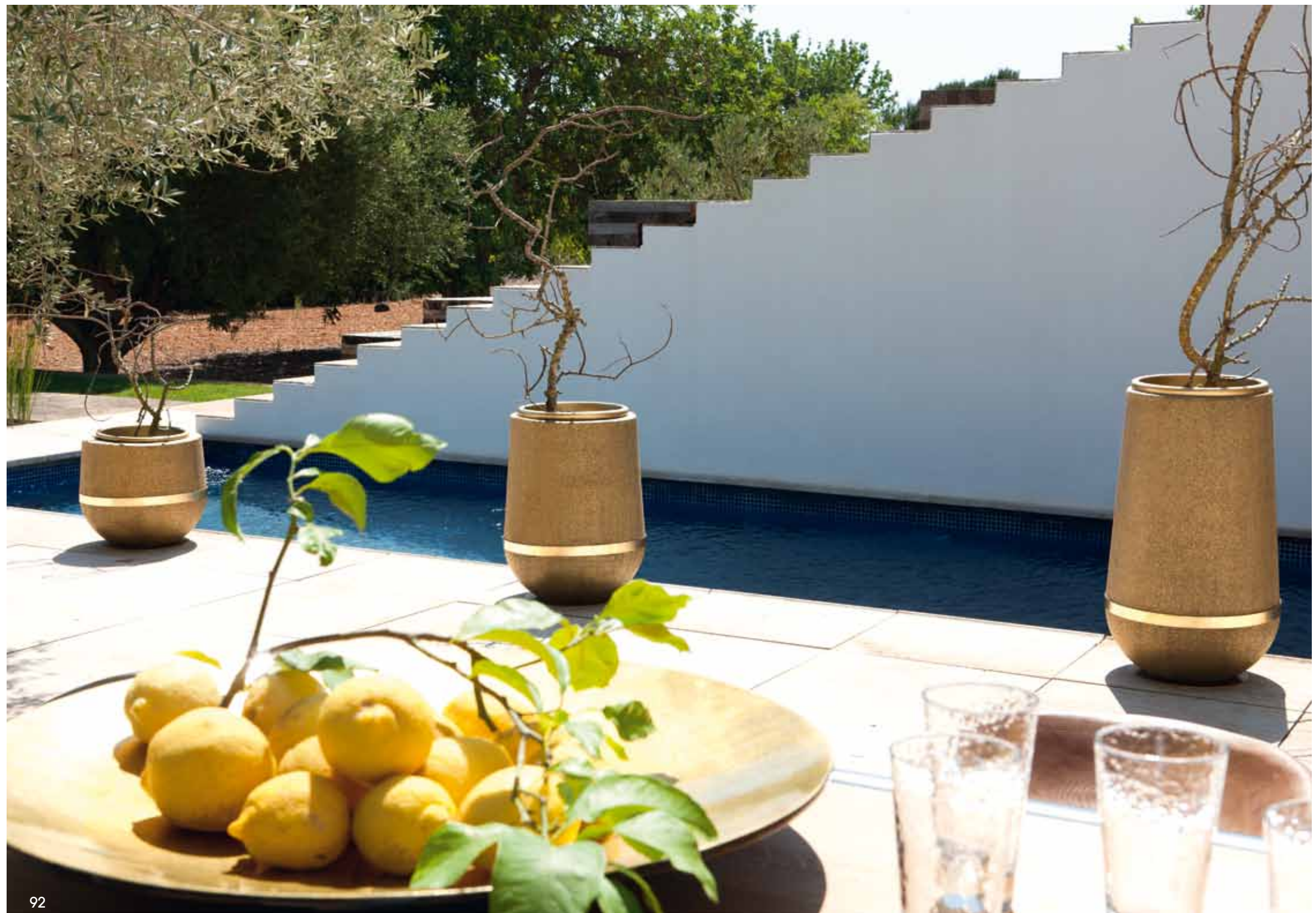

Delivery time

The delivery times are available upon inquiry. The dispatch date is stated with the confirmation of the order. Upon request, we also deliver and take over the assembly. The forwarding and assembly costs depend on the distance and scope of supply.

Scope of delivery

stilum play equipment is supplied complete incl. foundation bolts or anchor bolts and fastening material.

Assembly instructions and maintenance instructions are enclosed.

Replacement parts

The appropriate replacement parts for all stilum play equipment are always available. For reasons of safety and to meet the guarantee conditions, only original stilum replacement parts are to be used in repairs.

Also for reasons of safety and to protect the original stilum design, our replacement parts must only be attached to original stilum equipment.

stilum colouring

A typical characteristic of stilum design is the combination of silver-coloured steel and coloured rubber products.

Because other steel colours would impair the cheerful and high-quality appearance too much, we apologise that stilum equipment can only be produced from silver-coloured steel or stainless steel.

Custom-made equipment

If you have special wishes regarding an alteration to the ground-fastening for indoor assembly or of the colour variants of the rubber elements, please do not hesitate to contact us.

Product modifications

Due to the constant further development of our products and due to possible normative changes, we must expressly reserve the right to make technical and optical modifications to our products.

Installation depth

In our catalogue, next to the equipment descriptions, you will sometimes find different installation depths. These are required so that no danger of injury arises from the foundations. The installation depths are dependent on the type of floor being used or on the construction of the equipment.

To illustrate:

Installation depth »0«= play level:

The foundation is covered by the equipment or due installation/assembly on firm ground, no foundation is required.

Installation depth 150 mm:

When using synthetic fall protection or other firm ground, as these provide lasting cover for the foundation.

Installation depth 200 mm:

The installation depth can be shortened to 200 mm. This will be seen as a custom-made product and has to be declared separately when placing the order. Installation of synthetic impact protection is absolutely necessary.

Installation depth 450 mm:

When using loose filling materials such as sand or bark mulch, as these materials can succumb to a »wear- and-tear« effect.

All equipment is shown with their respective largest installation depths in our technical drawings.

stilum warranty

stilum grants following warranty terms:

10 years

- for all supporting/load-bearing construction elements.

5 years

- for all remaining parts. Excluded from this warranty shall be parts subject to wear.

for all remaining parts. Excluded from this warranty shall be parts subject to wear. Excluded from this warranty are all parts that are subject to wear and tear, these are in particular bearings, joints, shafts, chains, ropes, running surfaces, powder coatings.

Excluded from this warranty are also damages caused by:

- improper assembly which is not implemented according to our assembly instruction.
- wanton destruction and vandalism.
- insufficient maintenance by trained staff (according to DIN EN 1176-7, 8.2.2).

The warranty covers the delivery of equivalent spare parts. The warranty shall be valid from the date of delivery to the customer.

Precondition for the entry into force of the warranty is that the maintenance of our stilum products has to be executed by trained staff (according DIN EN 1176-7, 8.2.2) and also according to the guidelines of the employee. If necessary, a professional reparation using original spare-parts has to be made. The documentary of the proper maintenance (submission of the complete control and maintenance report shall be made according to the guidelines of DIN EN 1176, part 7) has to be performed by the employer and/or the operator of the playing equipment.



appealing design



constancy



distinctively



1. Scope of application, exclusion of the customer's general terms and conditions

stilm shall perform deliveries and services towards companies, legal entities under public law and special funds under public law only subject to the following General Terms and Conditions. stilm shall not accept customer's terms and conditions differing from or conflicting with these General Terms and Conditions, unless stilm explicitly confirms their validity in writing. The Terms and Conditions of stilm and the rejection of differing or conflicting terms and conditions of the customer will also be applicable if stilm, aware of differing or conflicting terms and conditions or the customer, performs deliveries and services to this customer without reservation.

In case of litigation, the German version of the General Terms and Conditions will exclusively prevail.

2. Conclusion of a contract

Quotations by stilm shall be without engagement and not binding, unless otherwise explicitly specified in the quotation. stilm shall be entitled to accept quotations made by the customers within a period of time of four weeks after their submittal. Declarations of acceptance as well as acknowledgements of order shall need to be in writing. In case of an execution of the order within the time limit for acceptance, the delivery note and/or the commercial invoice shall also be considered to be declarations of acceptance and/or acknowledgements of order.

3. Prices, terms of payment, default in payment

Deliveries and services for which fixed prices are not explicitly agreed shall be charged at the list prices applicable at the day of the conclusion of the contract; prices stated in catalogues, price lists etc. of stilm do not include the statutory value-added tax. This tax shall be stated separately to the statutory amount applicable at the day of invoicing. If an essential change in the price factors decisive for price calculation (e. g. increase in or lowering of prices of material, labour costs, freight charges or rates of customs) occurs, either contract party will be entitled to request the revision of prices by negotiation.

Payments of purchase prices shall become due immediately. Claims for compensation under a service contract shall become due at acceptance of the service. Default shall occur in case of a warning upon maturity, in any case, however, 20 days after maturity and receipt of an invoice or equivalent request for payment.

If the customer is in default of payment, stilm shall be entitled – notwithstanding further rights – to perform further deliveries to the customer only against advance payment.

4. Offsetting, retention

The customer will only be allowed to offset against own claims if these claims are uncontested or have been finally determined. The same shall apply for the exercise of rights of retention unless the right of retention is due to an intentional or grossly negligent breach of contract by stilm.

Besides, the customer will only be allowed to exercise a right of retention if its rights are founded on the same contractual relationship as the claims of stilm against which the customer asserts these rights.

5. Place of performance, passing of risks, storage

Place of performance shall be the registered office of stilm. Unless otherwise agreed, the delivery shall be performed "ex works".

The customer shall be responsible for loading. If the pick-up or shipment is accomplished by a forwarding agent or a carrier, the loading will be performed by this person as a vicarious agent of the customer.

The risks of accidental loss or accidental deterioration shall pass to the customer upon handing-over at the place of performance. If the goods or the services are ready for collection and the pick-up is delayed for reasons stilm is not responsible for, risks will pass to the customer upon receipt of the notice of readiness for pick-up.

If the goods or services are sent to the customer at the customer's request, the risks of accidental loss and of accidental deterioration will pass to the customer upon their delivery to the forwarding agent or the carrier, at the latest, however, upon leaving the works or the warehouse of stilm, regardless of who will bear the forwarding expenses. Unless otherwise agreed, the customer shall bear all costs of transport, transport insurance as well as customs duties. The customer shall have to make sure that the goods or services can be sent to it at the indicated address. If the delivery is not possible for impassability of the shipping point or similar obstacles, the customer will have to bear the additional expenditure arisen through the failed shipping.

6. Delivery times, force majeure, labour dispute

Terms for delivery and execution shall not be binding. Agreements on binding delivery dates need to be in writing. The delivery time will be complied with if by the end of the delivery period the readiness of the goods or the service for pick-up has been reported to the customer or the goods or services have been handed over for dispatch to the forwarding agent or the carrier.

Correct and timely self-supply out of concordant covering transactions of stilm shall be reserved.

stilm shall be entitled to carry out partial deliveries and to invoice them separately.

The compliance with the obligation of delivery by stilm shall require the timely and proper fulfilment of the obligations of the customer.

A default of stilm on account of a warning will only occur if this warning is in writing. A time limit for subsequent performance must be reasonable and must be fixed in writing. In case of doubt, a time limit of at least four weeks shall be considered to be reasonable.

stilm will not be responsible for delays in delivery and service due to force majeure and due to events making it more difficult or impossible for stilm to deliver or to perform the service through no fault of stilm – including but not limited to subsequently occurred difficulties in the procurement of materials, breakdowns, strike, lockout, shortage of staff, shortage of means of transport, administrative orders etc., even if they occur with suppliers, their sub-supplier or subcontractor, even in case of definitely agreed time limits and dates. They shall entitle stilm to postpone the delivery or the service by the term of the impediment plus a reasonable preparatory period or to completely or partly withdraw from the contract for the part not yet fulfilled. If the impediment persists for more than three months, the customer will be entitled to withdraw from the contract regarding to the part not yet fulfilled after fixing of a reasonable final deadline in writing.

If the delivery or service becomes impossible for stilm due to the above-mentioned circumstances, it will be exempted from its obligation of delivery or service.

7. Rights of stilm in case of breach of obligations by the customer

If the customer violates an obligation arising under the contractual relationship, as e. g. regarding the acceptance or pick-up of the goods or services or the acceptance of the service under the service contract, stilm will be entitled to withdraw from the contract after unsuccessful fixing of a reasonable time limit. If the client is responsible for the breach of duty, it will have to compensate stilm for the damages arisen due to that breach of duty or for the additional expenditure arisen (e. g. storage costs) in addition without a prior fixing or a time limit being necessary.

8. Reservation of title

stilm shall reserve the right of property of the goods until the complete fulfilment of the purchase price as well as the complete settlement of all claims under the business relationship with the customer.

The treatment and processing of the reserved goods shall be accomplished for stilm without obliging it. The customer shall be authorised and entitled to the sale, adjunction and confusion of the reserved goods only in the usual and proper course of business provided that the claims described in the following effectively pass over to stilm. The customer shall not

be entitled to dispose otherwise of the reserved goods, in particular to pledging and assignment as security. The customer shall assign to stilm already now all claims arising from the sale of the reserved goods or the adjunction or confusion of the reserved goods with other goods (including any balance claims from current accounts) to the amount of the value of the reserved goods together with any ancillary rights and any priorities in rank in relation to any other claims.

stilm shall accept this assignment. As the value of the reserved goods shall be agreed the amount invoiced by stilm plus a security of 10 % which is, however, not taken into account as far as third-party rights are conflicting with it.

In case of default in payment of the customer stilm shall be entitled to demand the goods back after unsuccessful fixing of a reasonable time limit for the payment. After the taking back of the goods, stilm shall be entitled to the best possible realisation. The realisation proceeds shall be charged up against the liability of the customer – minus reasonable realisation costs. In this case, the claim to performance of the customer shall become void. The taking back as well as the seizure of the reserved goods shall not constitute a withdrawal from the contract.

stilm shall confer the revocable right on the customer to collect the claims assigned to stilm for invoices of stilm on its own behalf as long as the customer fulfils its obligations towards stilm, does not make default and no application for the opening of insolvency proceedings or composition proceedings has been filed. On request, the customer shall have to communicate to stilm the names of the debtors of the claims assigned to stilm, to announce to assignment to them, to give all information on the claims assigned necessary for collection as well as to remit the documents required for collection. stilm shall be allowed as well to announce the assignment to the debtors.

stilm will be obliged to release securities if and as far as they exceed the claims to be secured by at least 20 %.

If third parties seize the goods reserved, the customer will be obliged to point to the privileged property and to inform stilm immediately on the seizure.

9. Warranty, product description

The warranty period for the purchase of new goods shall be two years beginning from delivery, unless a longer period is provided by law according to §§ 438 clause 1 no. 2 BGB (German civil code) (constructions or goods for constructions) or 479 clause 1 and/or clause 2 BGB (right of recourse). Rights to warranty in case of purchase of used goods shall be excluded.

If a notice of defects properly reported is justified, stilm will be entitled to proceed to a substitute delivery at its own option. stilm will not have the right of a subsequent delivery if and as far as the customer asserts claims under a right of recourse according to §§ 479 clause 1 and/or clause 2 BGB. If the substitute delivery fails, the customer will have the right at its own option to withdraw from the contract or to demand rescission of the contract (cancellation of contract) or the corresponding reduction of the agreed price (diminution) and/or to demand compensation for damages if the legal requirements are met.

After having detected a defect, the customer shall not be allowed to make changes to the goods delivered. Otherwise, any warranty shall be excluded.

If the defect has to be attributed to the specifications, to instructions made by the customer or to the material delivered or specified by the customer, stilm will be exempted from the warranty for these defects unless stilm failed to perform a communication incumbent on it on the defects to be expected.

Warranties of qualities of the goods or service need to be in writing. Information in advertising brochures shall not be binding and shall not constitute a warranty.

Unless otherwise agreed by the contract parties, the contractual use of the goods or services of stilm shall ensue from the intended use indicated in the product descriptions and catalogues. Defects resulting from the fact that the goods or services are used in a way not complying with the intended use indicated in the product descriptions and catalogues or that the customer chose another product or service than the product or service recommended by stilm for the use intended by the customer despite consultation by stilm, shall be excluded from warranty. Defects resulting from the fact that the customer did not install the

goods or services professionally according to the instructions given by stilm, shall be excluded from warranty. Slight colour deviations between the goods as well as with regard to colour charts are due to the production process and shall not entitle the customer to assert warranty claims. With respect to length and width, dimensional tolerances of +/- 1% are acceptable, with respect to thickness the tolerance is +/- 2mm. Minor deviations in the colours of the goods when comparing them to each other or to colour samples have to be attributed to the production process and do not entitle the customer to claim warranty. The surface cover is subject to wear depending on the sort and way of how it is used. These wear marks, which may lead to visible differences in colour, are inherent in the product and do not represent a fault. Intensive UV-light may lead to minor discolouration of the surface, apart from having a slight chalk effect, which, however, does not interfere with other factors of lasting quality. Impact protection figures measured and certified according to (HIC 1000) EN 1176/77 refer to the quality of the goods or services at the time of delivery. They may be subject to changes, depending on the place of application, the environment and the influence of external factors during their useful life. Using the goods or storage them in a permanently damp environment may lead to changes in shape, mouldy spots, the development of algae or similar phenomena as results of dampness.

They can be subject to changes depending on the type of use, the environment and the influence of external circumstances during use.

In the event of a notice of defect the customer shall be obliged to a reasonable extent to describe the defect as explicitly as possible. This includes in particular the description of the subsoil, the way of installation, the atmospheric influences and other influences as well as the transmission of significant detailed pictures.

10. Restriction of liability

stilm will only be liable for damages if it or one of its vicarious agents has breached an essential contractual obligation (cardinal obligation) in a way endangering the purpose of the contract or if the damage is to be attributed to gross negligence or intent by stilm or one of its vicarious agents. If the culpable infringement of an essential obligation (cardinal obligation) is not made grossly negligently or wilfully, the liability of stilm will be limited to the damage reasonably foreseeable for it at the conclusion of the contract.

The customer shall be obliged to inform itself on the qualities, proper use as well as existing risks, in particular with regard to an improper use, of the products and to convey this information to its customers as well. A liability of stilm for damages arising from improper use of the products shall be excluded. The restrictions of the liability of stilm mentioned above shall apply to contractual and non-contractual claims. The liability under compulsory legal provisions, contractual agreement or warranty as well as for personal injury and its consequences shall remain unaffected.

11. Exclusion of assignment

The assignment of claims of the customer that are no monetary claims shall need the written consent of stilm. stilm shall only refuse its consent in case of material reasons.

12. Place of fulfilment, place of jurisdiction, applicable law

The place of fulfilment for all obligations under the contractual relationship shall be the registered office of stilm. Unless another exclusive place of jurisdiction is provided by law, the exclusive place of jurisdiction shall be the registered office of stilm GmbH, Gewerbegebiet Larseck, 56271 Kleinmaischeld (Germany). Besides, stilm shall be entitled to sue the customer at its general place of jurisdiction. These General Terms and Conditions and the entire legal relations between the contract parties shall be subject to the law of the Federal Republic of Germany, the provisions of the United Nations Convention on Contracts for the International Sale of Goods (CISG) being excluded.

stilm GmbH
Gewerbegebiet Larseck – 56271 Kleinmaischeld
as of: 24 Aug. 2005



Rubber Granule



Stainless Steel



Hardwood

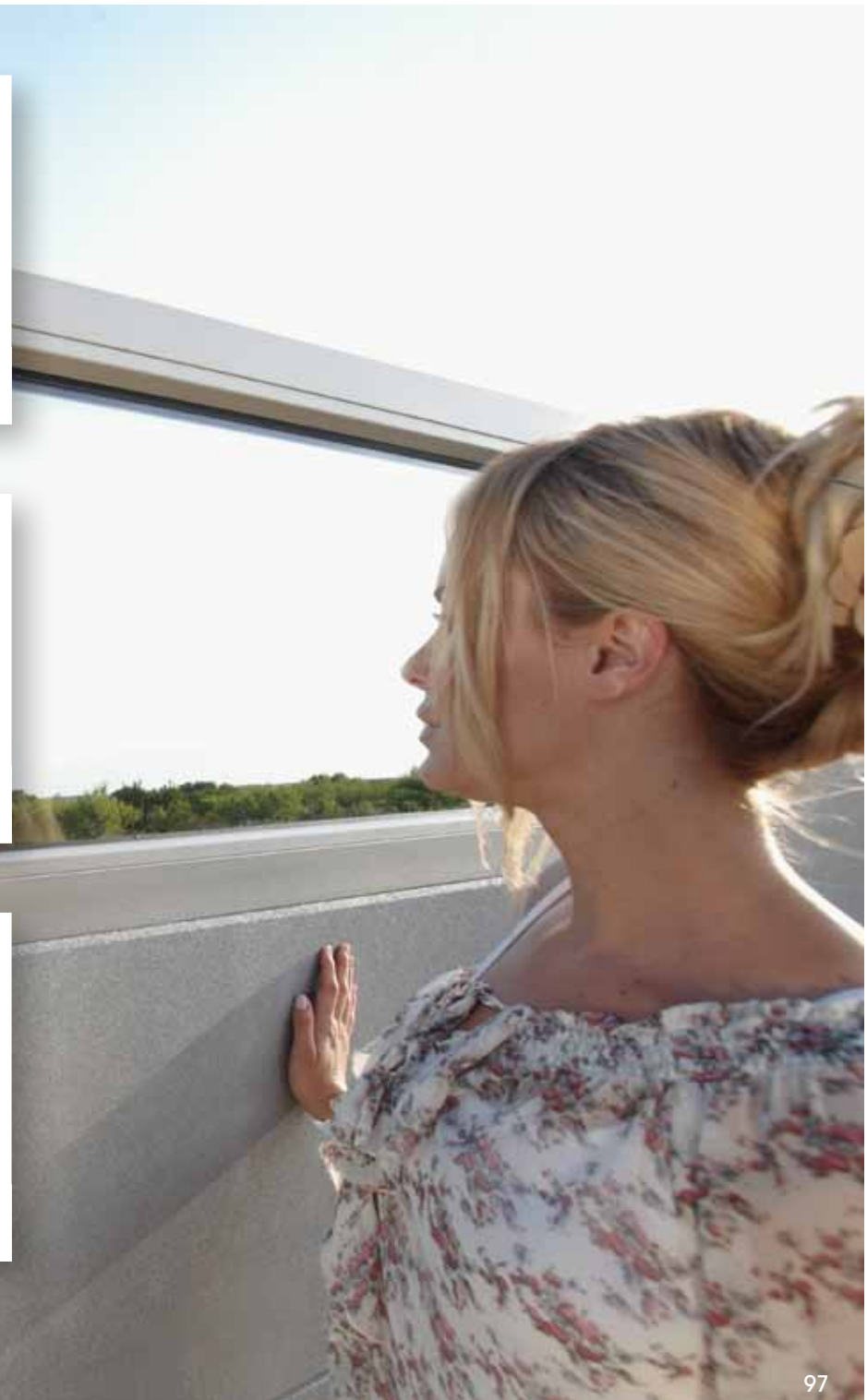



Play and Sports Ltd
1 Castleton Grove, Glasgow G77 5LH
0141 280 1914 (t)
mail@playandsports.co.uk www.playandsports.co.uk

